

ALABAMA COUNSELING ASSOCIATION

55th Annual Conference
November 17 - 19, 2021
Birmingham, Alabama

“Rejuvenate:
Reigniting Purpose and Passion”

TABLE OF CONTENTS

Message from ALCA President.....	3
ALCA History and Overview.....	4
ALCA Presidents and Conferences	5
Pre-Conference Activities	6
Conference General Information.....	7
Annual Conference in Brief	12
Conference Site Maps	13
Keynote Speakers.....	19
Sessions Schedule with Locations.....	22
Content Sessions - Wednesday.....	30
Content Sessions - Thursday	41
Content Sessions - Friday.....	62
ALCA Leadership	67
Chapters, Divisions & Affiliates Index	69
Exhibitors/Advertisers.....	70
Advertisements/Promotions	72
Sponsors	87
Important Forms.....	90

ALABAMA COUNSELING ASSOCIATION

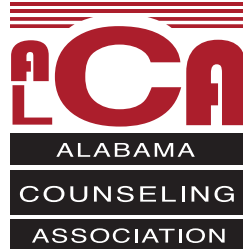

“Rejuvenate:
Reigniting Purpose and Passion”

Founded in 1954
(1966 became a part of the American Counseling Association)

ALCA has enjoyed remarkable growth
and success in its long history.

Today it has a membership of approximately 2200 members
comprised of nine Chapters and thirteen Divisions.

Let’s celebrate the dedication of our members statewide
in our schools, colleges, agencies, institutions, and
communities.

Our members are among the finest counselors in Alabama.

They are School Counselors... College Counselors...
Marriage and Family Counselors....
Educators and Supervisors.... Career Counselors...
Mental Health Counselors... Groupwork Specialists...
Rehabilitation Counselors...
Addictions and Offenders Counselors...
and Counselors in Private Practice.

They share one Vision of caregiving regardless of the specific nature of their work,
location or specialty ~ they are all Counselors!

MESSAGE FROM THE ALCA PRESIDENT

YULANDA TYRE



Welcome to the 2021 Alabama Counseling Association Annual Conference. This year's theme is **Rejuvenate: Reigniting Purpose and Passion**. Last year was filled with a great deal of unknowns because of the COVID-19 Pandemic. While many issues caused by the pandemic are not resolved, there are many things that we learned about ourselves and the profession that have encouraged and inspired us to continue to pursue our passion and purpose in service to others.

During the conference I would like to encourage engagement in some rejuvenating practices. Safely connect with colleagues, professional peers, mentors, and mentees. Face to face connection is something that I know many of us missed in the prior year. Also stop by and visit the conference vendors and sponsors! They each have worked hard to bring a variety of resources to support the needs of counselors and counselor educators. Engage intellectually with the conference presenters, in over 90 professional topics and be sure to connect w the amazing line up of keynote speakers. The current ACA President, Dr. S. Kent Butler, Jr., is scheduled to kick off the conference, followed by two outstanding professionals in the field, Joyce Marter and Dr. Maranda Brown. They each will be speaking to various aspects of counselor wellness, passion, and purpose.

This year the conference will again host the Graduate Student Poster Session, the New Member and First Time Attendee Reception, and the Chi Sigma Iota Recognition. You notice a few new things as well! Wexford, will sponsor, the popular Thursday morning Awards breakfast and ALMHCA will sponsor The LPC/ALC Roundup. New and seasoned professionals will not want to miss these opportunities to connect and support these events.

I would like to personally invite you to stop by each of the photo booth stations set up around the conference. Capture your moments to save or share with others. Also mark your calendar to attend the Thursday night Re“Groove”-inate Dance! Come dressed in your best 70's attire and be prepared to “JAMM” out. What's a conference without music, connection, and laughter!!!

Thank YOU for choosing ALCA! I understand that you many make sacrifices to attend, some include leaving family, co-workers, students, and clients behind to attend. Your choices are not going unnoticed. I look forward to connecting with you here.

Dr. Yulanda Tyre, ALCA President

Dr. Yulanda Tyre has a PhD in Counselor Education and serves as Associate Professor at Liberty University in the Department of Counselor Education and Family Studies. She has 18 years' experience as a counselor, counselor educator, author, and higher-education leader. She is a licensed counselor, supervisor, and a Nationally Board-Certified Counselor. She also serves the profession in her community as board member for the Montgomery Area Mental Health Authority and is Junior League of Montgomery Sustainer. She is Past-President for the Alabama Association for Counselor Educators and Supervisors, the Alabama College Counseling Association, and prior Chair of Current Issues and Trends for the Alabama Counseling Association. Dr. Tyre recently served as Treasurer of the American College Counseling Association for 2019-2020. Dr. Tyre is owner of Reignite, Counselor, Coach and Consultation Service and author of Reignite, a 21 Day Devotional. She is committed to helping others realize, renew, and ignite their talents, dreams, and goals.

ALABAMA COUNSELING ASSOCIATION

History and Overview

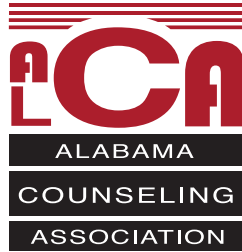

The Alabama Counseling Association had its inception in 1954 as the Alabama Guidance Association, a locally organized, autonomous group. For years this group held state conventions and generally promoted professional development for counselors.

In 1964, during the Guidance Association's state convention at the Dinkler-Tutwiler Hotel in Birmingham, the question of national affiliation was discussed. With that question as impetus, then President Wilbur Tincher appointed a committee of seven to study the possibility of affiliating with the American Personnel and Guidance Association (APGA). Following discussions with and visits from American Personnel and Guidance Association representatives Willie Dugan, Kenneth Hoyt, and C. Winfield Scott, the committee proposed affiliation on February 14, 1966.

A proposed new constitution aligning the state organization with the American Personnel and Guidance Association constitution was presented at the 1966 state meeting in Montgomery. The membership approved the new constitution and endorsed the alignment. The Alabama Guidance Association then petitioned for national affiliation with APGA. Application for formal recognition was made in the Fall of 1966. Acceptance by the Senate of the American Personnel and Guidance Association was soon forthcoming. The charter for affiliation of the Alabama group was presented at the national convention of the American Personnel and Guidance Association in Dallas, Texas, in 1967.

On November 18, 1983, the General Session of the Alabama Personnel and Guidance Association voted to change its name to the Alabama Association for Counseling and Development in compliance with the national association's change to the American Association for Counseling and Development.

In the business session at its twenty-fifth Annual Conference in Huntsville in 1992, the state organization changed its name to the Alabama Counseling Association (ALCA) following the lead of the national organization once again, now identified as the American Counseling Association.

ALCA has enjoyed remarkable growth and success in its long history. Today it has a membership of approximately 2200 members comprised of nine chapters and thirteen divisions and affiliates. Each year the annual conference includes nationally known keynote speakers and a variety of professional opportunities. As the Association has grown, it has continued to add services for its members.

ALABAMA COUNSELING ASSOCIATION

Roster of Presidents

1965 - 1966	Wilbur Tincher*	1994 - 1995	Thelma Robinson
1966 - 1968	Clay Sheffield*	1995 - 1996	Margaret (Meg) Smith
1968 - 1969	Frances Davis*	1996 - 1997	Cheri Smith Fitzhugh
1969 - 1970	John Seymour*	1997 - 1998	Marcheta Evans
1970 - 1971	Reba Clark	1998 - 1999	Sherry Quan
1971 - 1972	Richard Ward	1999 - 2000	Ingie Burke Givens
1972 - 1973	Ethel Hall	2000 - 2001	Carol Turner*
1973 - 1974	Hugh Donnan	2001 - 2002	Nancy W. Cole
1974 - 1975	Leeman Joslin*	2002 - 2003	Annette P. Bohannon
1975 - 1976	Nell Oden	2003 - 2004	P. Irene McIntosh
1976 - 1977	Fannie Cooley*	2004 - 2005	Michael Lebeau
1977 - 1978	Sanford Colley	2005 - 2006	Paul F. Hard
1978 - 1979	Don Schmitz*	2006 - 2007	Shirley L. Barnes
1979 - 1980	Barbara Echols Jackson*	2007 - 2008	Jerri Lynn Morrow
1980 - 1981	Mary McKinnon Ledford*	2008 - 2009	Katharine Nichols
1981 - 1982	Jean Cecil*	2009 - 2010	Judy Childress*
1982 - 1983	Don Belcher	2010 - 2011	Nancy Fox
1983 - 1984	Richard Canada	2011 - 2012	Melanie Drake Wallace
1984 - 1985	Susan Parker	2012 - 2013	Necoal Driver
1985 - 1986	Nancy Fortner	2013 - 2014	Nancy Wolfe
1986 - 1987	Linda Mahan	2014 - 2015	Donna Clark
1987 - 1988	Anne Hartline	2015 - 2016	Vincent D. Hinton
1988 - 1989	Bob Comas	2016 - 2017	Margaret Fox
1989 - 1990	Ervin (Chip) Wood*	2017 - 2018	Tomeka W. McGhee
1990 - 1991	Helen McAlpine	2018 - 2019	Monica P. Mack
1991 - 1992	Paulette Pearson	2019 - 2020	Leslie Weaver-Martin
1992 - 1993	Karole Ohme	2020 - 2021	Jacques L. Austin
1993 - 1994	Joe Creel		

* **DECEASED**

ALABAMA COUNSELING ASSOCIATION

Upcoming Conferences

2022	Mobile
2023	TBA

ALCA ANNUAL CONFERENCE



Pre-Conference Activities
Tuesday, November 16, 2021

Early Registration
3:00-5:00 PM
Sheraton Birmingham Hotel
Birmingham Ballroom Pre-Function Area

Exhibit Hall Setup Begins at 1:00 PM

The ALCA Executive Council Meeting
6:00-8:00 PM
The Forum B

The ALCA President's Reception
(For Executive Council Only)
President's Suite Room #943 Westin Hotel
8:15-9:00 PM
Sponsored by ACT

ALCA ANNUAL CONFERENCE

General Information

Covid-19 Pandemic Safety

Covid-19 pandemic safety measures should be observed at all times. Please wear the mask provided in your conference materials while attending the conference. Sanitizing stations are set up around the conference areas, so please frequently use those. Please select your preferred colored wrist band obtained at the registration area and wear so others will know how you want to interact. The choices are as follows: 1) Green = I'm All In: Give me a Hug. 2) Yellow = I'm (Almost) All In: Fists & Elbow Bumps Only. 3) Red= I'm Still Cautious: Maintain 3 feet distance

Awards Breakfast

The ALCA Annual Conference will kick off with the Awards Breakfast on Wednesday, November 17, 8:00 - 9:30 AM, in the Birmingham Ballroom XI & XII. The breakfast is sponsored by the Home Builders Association of Alabama. Join us in honoring our volunteers, leaders and workers, and those who have distinguished themselves during the past year.

Professional Development Hours Available



The Alabama Counseling Association has been approved by NBCC as an Approved Continuing Education Provider, ACEP No. 2001. Programs that do not qualify for NBCC credit are clearly identified. The Alabama Counseling Association is solely responsible for all aspects of this program.

The procedure for requesting NBCC contact hours for the 2021 ALCA Annual Conference is as follows: The professional development request form is included in this 2021 ALCA Annual Conference Program Book. New this year is an electronic CE application which can be submitted via this link <https://alca.memberclicks.net/2021alca-person-ce-certificate--request> with debit/credit card payment (\$5 Members/\$20 Non-members). The deadline for receipt of professional development requests is January 31, 2022. Certificates for Annual Conference attendance will be emailed no later than March 31, 2022. Requests submitted after January 31, 2022, will cost \$20. Replacement certificates will cost \$20.

You must be registered for the conference to claim professional development (NBCC contact hours) credit. NBCC contact hours' credit documentation will not be issued until applicant's check clears bank or electronic payment is made. You may earn as many as 14 NBCC contact hours for the total conference. Presenters may not receive professional development credit for their own presentations. The professional development request form is included in the back of this program booklet and also on the electronic link <https://alca.memberclicks.net/2021alca-person-ce-certificate--request>. Complete the form in its entirety according to the provided directions. Submit payment electronically via credit/debit card or return the form along with a check for \$5.00 (\$20 for non-members) made payable to ALCA to:

Dr. Deborah Grant

ACEP Program Coordinator | 2705 Royal Lane | Pelham, AL 35124

NOTE: This conference is also approved to provide credit for social worker hours. Please check statement on the form (electronic or printed) indicating intent to submit certificate to the Alabama State Board of Social Work Examiners.

Certificate of Attendance

Certificates for Annual Conference attendance (not NBCC-related) may be requested in writing from the ALCA State Office. Please email your request to alca@alabamacounseling.org or mail to ALCA, PO Box 131425, Birmingham, AL 35213-1425.

ALCA ANNUAL CONFERENCE

Colleagues with Disabilities

ALCA and its leaders and members are committed to ensuring you enjoy, benefit, and totally participate in the ALCA conference. Please let the members of our Conference Team know if you have special needs or if someone you know needs special assistance during the conference. ALCA is committed to your full participation in our conference, and we will respond to your needs as fully as possible. Contact Dr. Necoal Driver (334.324.8512), Dr. Laventrice Ridgeway (251-635-5021) or Dr. Nancy Fox (205.423.5989).

Exhibits

Exhibits will be located in the Birmingham Ballroom I, V, and IX. The exhibits will offer materials to fill many counseling needs including audio visual aids, printed and other resource materials, college selection aids, books and career information. The exhibits will be open:

Wednesday, November 17, 8:45 A.M. - 5:00 P.M.

Thursday, November 18, 8:00 A.M. - 4:00 P.M.

Please look for the list of the exhibitors in the back of this program booklet and take time to thank them during the conference.

Complimentary Breakfasts

Thanks to the generosity of our sponsors, attendees to the ALCA Annual Conference can enjoy free breakfasts during the conference. You are invited to join us for these breakfast events:

Wednesday, November 17, 8:00 AM / Birmingham Ballroom XI & XII / Sponsor: Home Builders Association of Alabama (Awards Ceremony). Serving of food will stop once program begins.

Thursday, November 18, 7:00 AM / Birmingham Ballroom XI & XII / Sponsor: Wexford Health Services

Friday, November 19, 7:30 AM / Birmingham Ballroom Pre-Function Area / Amridge University

Internet Access

The Sheraton Hotel has internet access in all guest rooms. There is a fee. It also has a first floor internet cafe and business center available. Wi-Fi is available in the Sheraton and also in the BJCC Medical Forum & East areas.

Charging Stations

Phone charging stations will be available at no charge in the Sheraton Hotel Exhibit area as well as on the first floor of the Medical Forum.

A Note about Our Exhibitors and Sponsors

Please remember that our exhibitors and sponsors spend a great deal of money (often thousands) providing food and drinks for breaks, meals, receptions, and giveaway items. They and their organizations do not owe us this generosity. Rather they do it to support us. Remember your manners. Don't get more than your fair share. If they run out of an item, understand. Don't be mad! Be appreciative that they did what they could. Your actions reflect on all of us - the ALCA, the counseling profession, as well as you, the professional counselor.

School Counselor Roundup

The School Counselor Round-Up is scheduled for Wednesday, November 17, 2021 from 1:30pm-4:15pm. This special session is open for all school counselors from novice to experienced counselors. Counselors from across the curriculum will share their programs and ideas. Please feel free to come and go. The different times for each presentation are listed in the content sessions' area.

New School Counselor Academy

This session has been designated as one of the professional development opportunities to meet state certificate requirements as a new Alabama School Counselor (less than three years of experience). Experienced school counselors and state department personnel will review the most recent state standards, ethics for school counselors, and provide new counselors with resources which will assist them in providing a quality school based counseling program. If you are a new counselor, this session is for you. This session is scheduled for Thursday, November 18, from 1:30pm - 4:15pm in the Birmingham Ballroom.

LPC/ALC Roundup

The LPC/ALC Roundup is sponsored by the Alabama Mental Health Counselor Association (ALMHCA). This specialized session is for Licensed Professional Counselors (LPCs) and Associate Licensed Counselors (ALCs) on Thursday, November 18, 1:30pm - 2:45 pm in Medical Forum C. Welcome LPCs and ALCs!

Consent to Use of Photographic Images

The registration and attendance at or participation in ALCA meetings and other activities constitutes an agreement by the registrant to ALCA's use and potential distribution of the registrant or attendee's image in photographs, videos, social media formats and electronic reproductions of such events and activities.

The Good Neighbor Plan - A Word to Our Out-of-State Colleagues

The Alabama Counseling Association has a reciprocal agreement with the other state branches of ACA, AMHCA, and ASCA in the Southern Region. If you are from Florida, Georgia, Tennessee, Mississippi, or Louisiana, you may take advantage of our discounted member's rate for the conference if you send proof of your current membership in your own state's professional counseling association. Proof of membership may be current membership card with date, a letter of confirmation from your state's association, or some other form of verification. Those registering on-site must bring similar proof. We are glad to extend this courtesy to our colleagues from other states in the Southern Region of ACA!

Celebration Dance

The Celebration Dance will be held on Thursday night in the Birmingham Ballroom and will feature "JAMM" and lots of door prizes. Come!

Cellular Phones & Pagers

Out of courtesy and respect, and for everyone's benefit and enjoyment during the content sessions and other meetings, please disengage cellular phones, pagers, watch alarms, and any other electronic device that might make noise. Thank you for your assistance with this request.

Tax Deduction of Expenses

An income tax deduction may be allowed for expenses of education (including registration fee, travel, meals, and lodging) undertaken to maintain and improve professional skills and paid personally. Keep your records and consult your tax professional.

Division/Affiliate Luncheons

Reservations for division/affiliate luncheons will be made directly with division leadership. There generally is an additional fee for these.

Name Tags/Admission Tickets

Your name tag (badge) will serve as your admission to all conference programs. Please wear it at all times. You will not be allowed to enter program rooms, general sessions, or the exhibit area without your badge. Please acquire it in advance at the registration table.

New Member and First Time Attendee Celebration

Welcome new ALCA members and first time attendees to your first ALCA Annual Conference! We would love to get to know you and officially welcome you. Please join us for the New Member and First Time Attendee Celebration.

Photo Booth

ALCA has provided a couple of Photo Booth opportunities at the conference. The official ALCA 2021 Conference Photo Booth is found at the end of the hallway noted as you exit the escalator in the Sheraton (on the route to registration). Another is a surprise...see if you can find it! This one is more creative.



YOU ARE INVITED TO THE

Alabama Counseling Association's
Celebration Dance

Re-“Groove”-inate Theme
70s Dress – Come Groove with us!

Thursday, November 18

8:30 pm - 11:00 pm

Birmingham Ballrooms

Music by “JAMM”

Legal Liability Issues for Counselors in Alabama -- \$20.00

To Order, Submit Written Request and Check to:

Dr. Nancy Fox

ALCA Executive Director

P. O. Box 131425

Birmingham, AL 35213-1425

ALCA Graduate Student Reception & Graduate Student Poster Session

Reception – Thursday, November 18, 2021 | 11:45 am – 1:00 pm

Poster Session – Thursday, November 18, 2021 | 1:30 pm – 3:30 pm



Alabama Council on Compulsive Gambling (ALCCG)

THANK YOU TO ALCCG FOR SUPPORTING THE GRADUATE STUDENT POSTER SESSION!!!

For questions about the poster session, contact Vincent D. Hinton at vincentdhinton@yahoo.com or
Dr. Latonya Graham at drlmgraham@gmail.com

2021 ALCA ANNUAL CONFERENCE

Conference in Brief

Tuesday, November 16, 2021

1:00 pm	Exhibit setup begins
3:00-5:00 pm	Conference Registration
6:00-8:00 pm	ALCA Executive Council Meeting
8:15-9:00 pm	President's Reception for Executive Council - Sponsored by ACT

Wednesday, November 17, 2021

8:00-9:30 am	Awards Breakfast - Sponsored by Alabama Home Builders Association
7:30 am-4:00 pm	Conference Registration
8:45 am-5:00 pm	Exhibits
10:00 am-Noon	OPENING GENERAL SESSION - Keynote: Dr. S. Kent Butler
1:30-4:30 pm	School Counselor Roundup
1:45-3:00 pm	CONTENT SESSIONS
3:00-3:15 pm	Break
3:15-4:30 pm	CONTENT SESSIONS
4:30-4:45 pm	Break
4:45-5:30 pm	Division/Affiliate Meetings
5:45-6:30 pm	New Member & First Time Attendee Celebration Sponsored by the Alabama Council on Compulsive Gambling
5:45-6:30 pm	Chapter/Division/Affiliate Presidents and President-Elects Meeting
6:30-7:30 pm	School Counselor Reception Sponsored by Bryant-Jordan Scholarship Program

Thursday, November 18, 2021

7:00 am-8:15 am	Wexford Health Breakfast
7:30 am-3:00 pm	Conference Registration
8:00 am-5:00 pm	Exhibits
8:30-10:15 am	GENERAL SESSION - Keynote: Joyce Marter
10:15-10:30 am	Break
10:30-11:30 am	Retired Counselors Reception
10:30-11:45 am	CONTENT SESSIONS
11:45 am-1:00 pm	Graduate Student Reception
11:45 am-1:15 pm	Division/Affiliate Luncheon
1:30-3:30 pm	Graduate Student Poster Session Sponsored by ALCCG
1:30-4:15 pm	New School Counselor Academy
1:30-2:45 pm	LPC Roundup
1:30-2:45 pm	CONTENT SESSIONS
2:45-3:00 pm	Break
3:00-4:15 pm	CONTENT SESSIONS
4:15-4:30 pm	Break
4:30-5:45 pm	CONTENT SESSIONS
4:30-5:45 pm	Past-Presidents Reception
5:45-6:30 pm	Chapter Meetings/Socials
8:30-11:00 pm	Dance (Re-"Groove"-inate Theme) 70s Attire

Friday, November 19, 2021

7:30-8:15 am	Biscuit Breakfast –Sponsored by Amridge University
8:30-10:15 am	BUSINESS & GENERAL SESSION - Keynote: Dr. Maranda Griffin
10:30-11:45 am	CONTENT SESSIONS
Noon-1:00 pm	Conference Committee Meeting

CONFERENCE SITE MAP AND PLANS **The Forum Conference Center Second Floor**

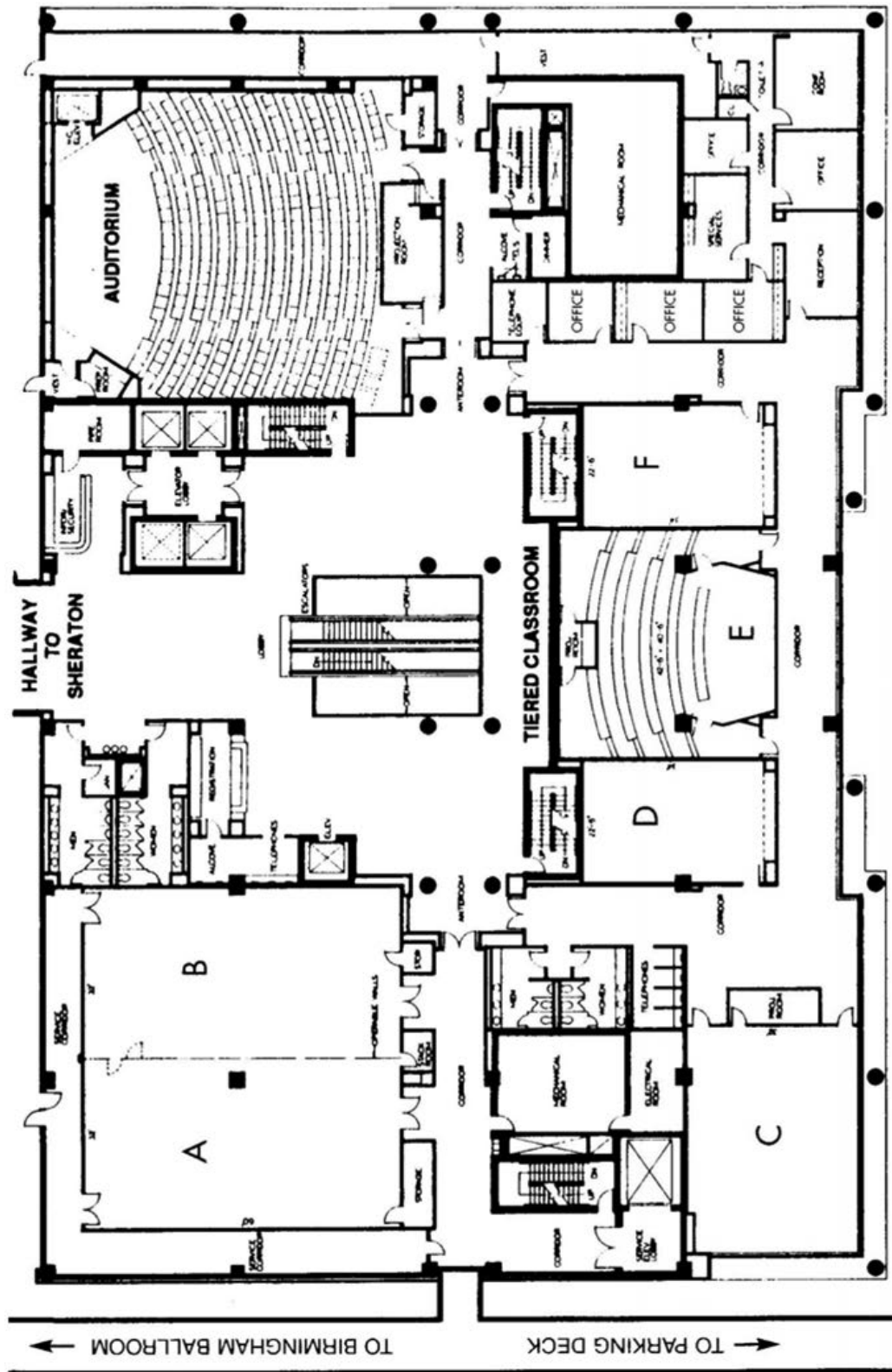

Locations of Rooms A, B, C, D, E, F and Auditorium

CONFERENCE SITE MAP AND PLANS
The Forum Conference Center
Third Floor

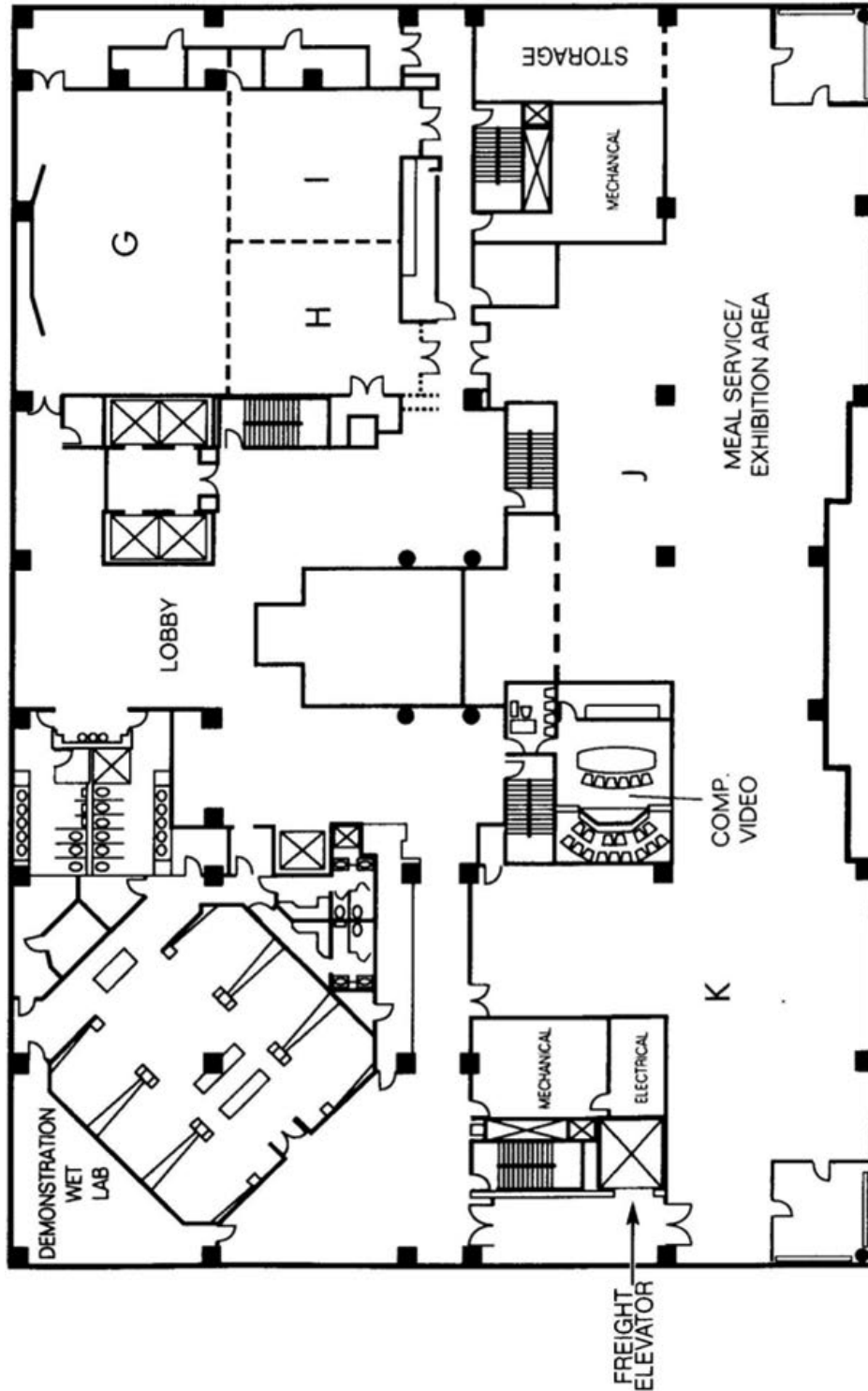

Locations of Rooms G, H, I, J-K

CONFERENCE SITE MAP AND PLANS

Birmingham Ballroom

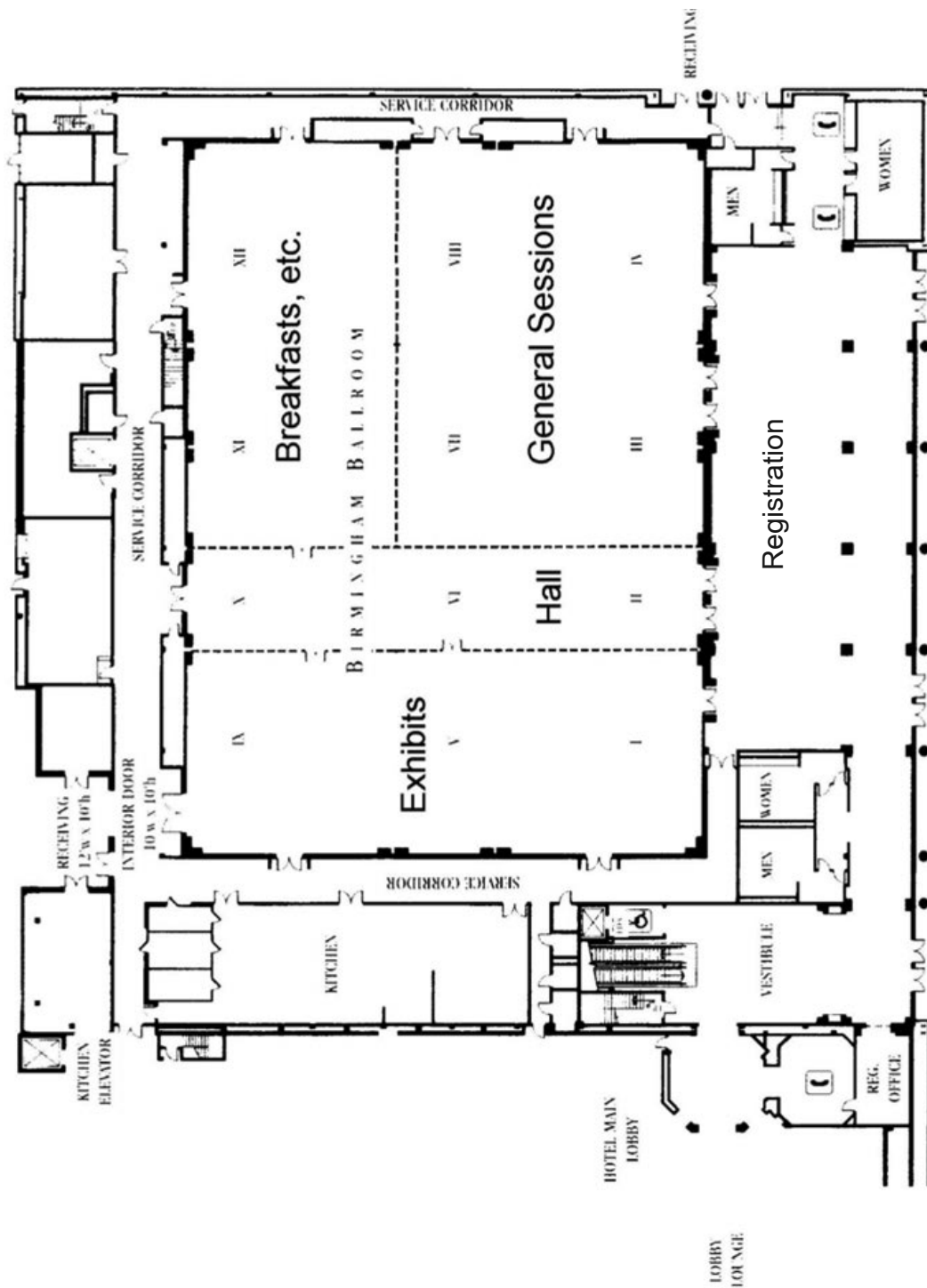

Location of All Sheraton Birmingham Ballroom Venues

CONFERENCE SITE MAP AND PLANS

Birmingham-Jefferson Civic Center

First Floor

NOTE: The Skywalk over the street on 2nd Floor of Hotel leads directly to East Meeting Rooms

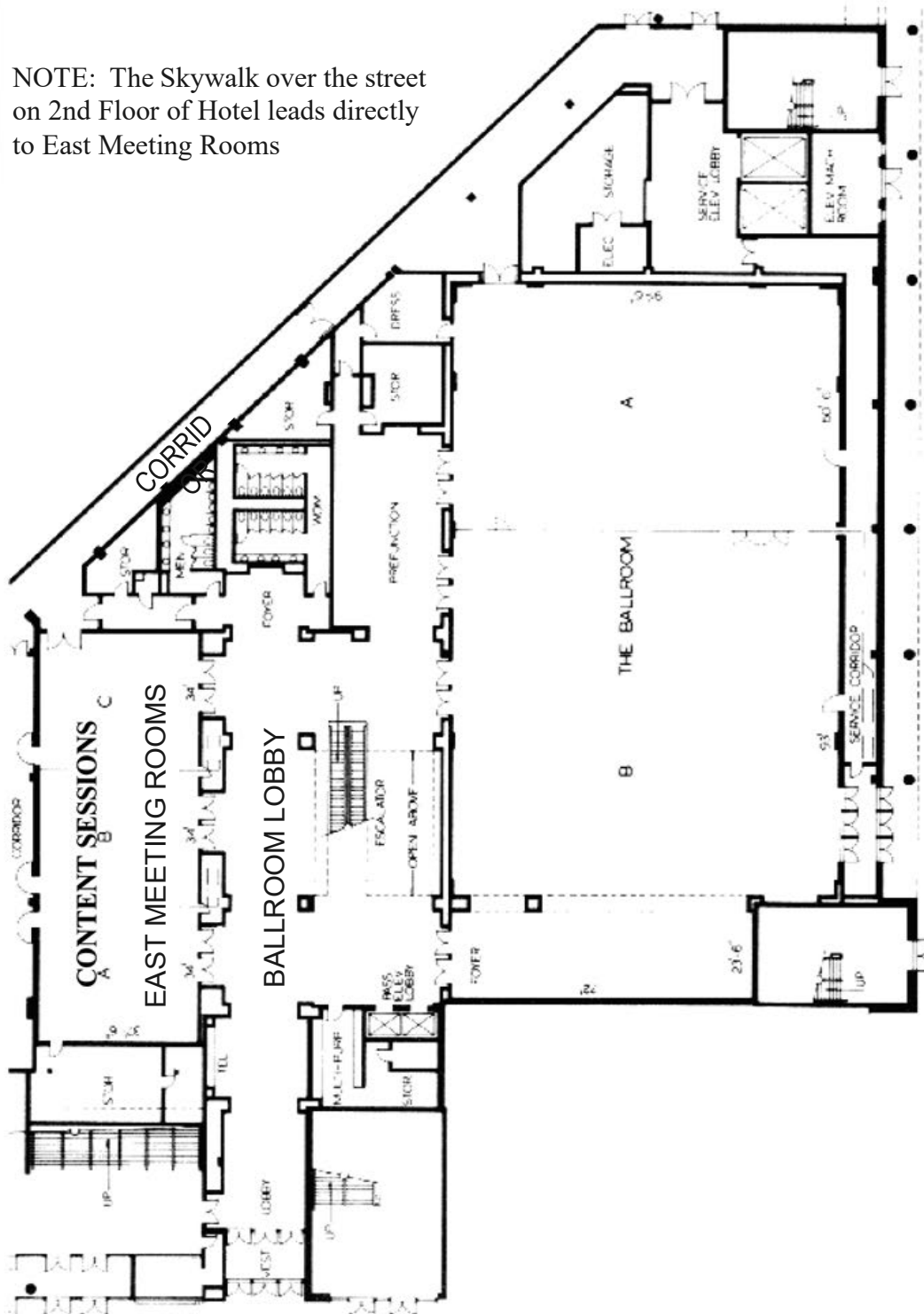

**Location of East Meeting Rooms A, B, C
in BJCC**

CONFERENCE SITE MAP AND PLANS
Birmingham-Jefferson Civic Center
East Rooms (Downstairs)

NOTE: The Skywalk over the street on 2nd Floor of Hotel leads directly to East Meeting Rooms

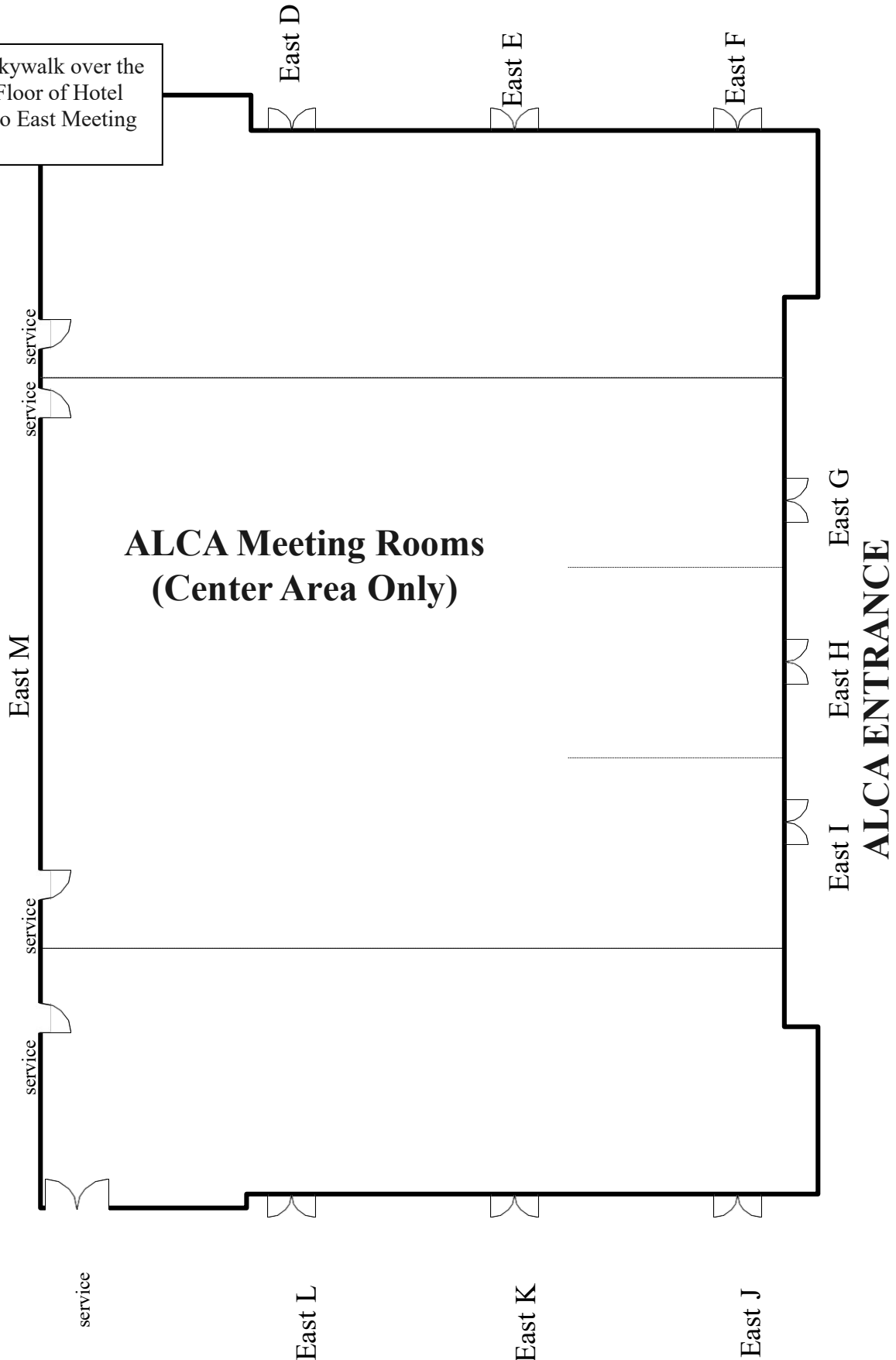

CONFERENCE SITE MAP AND PLANS

Birmingham-Jefferson Civic Center East

Rooms (Upstairs)

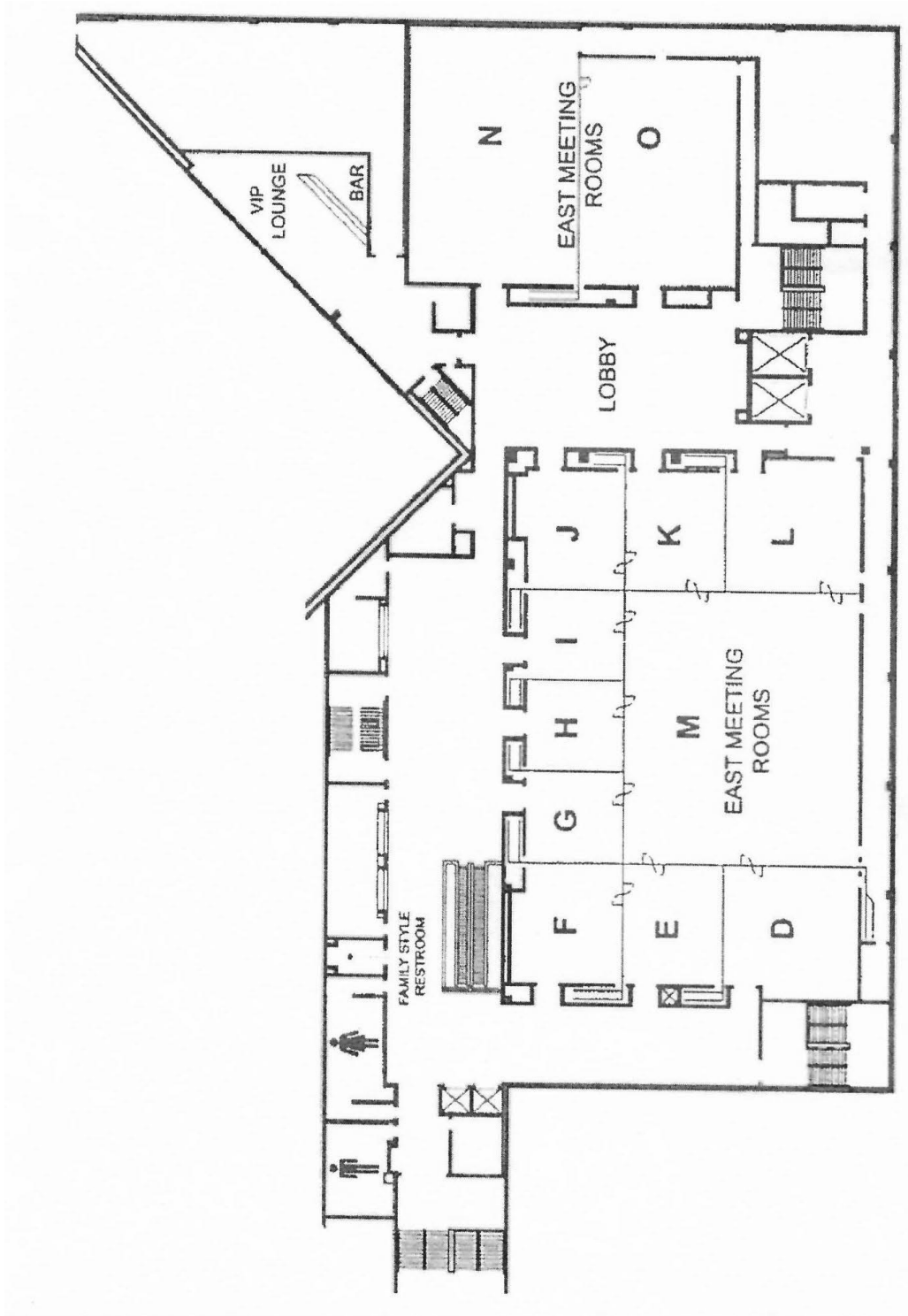

KEYNOTE SPEAKER

Dr. S. Kent Butler, Jr.

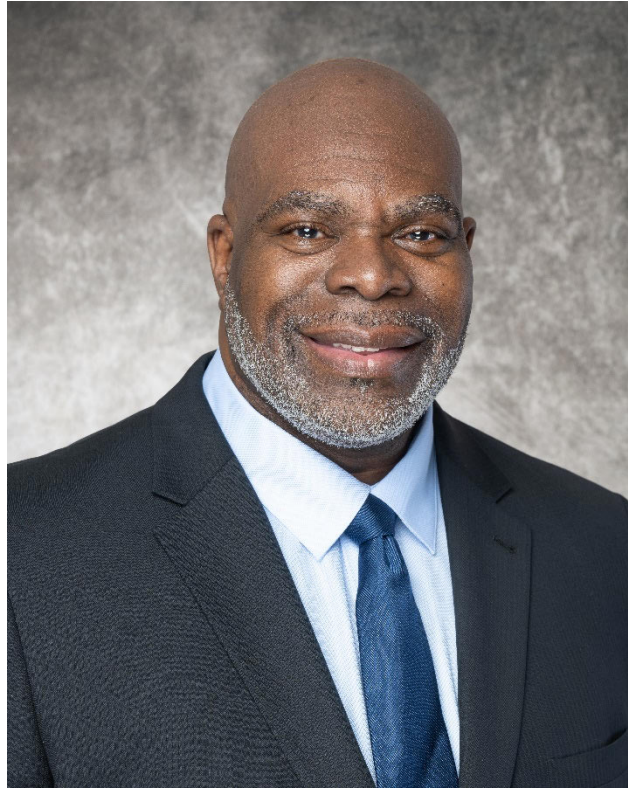

S. Kent Butler, Jr. holds a Ph.D. in Educational Psychology, with a concentration in Counseling Psychology, from the University of Connecticut. He is a Licensed Professional Counselor (LPC), Nationally Certified Counselor (NCC), and Nationally Certified School Counselor (NCSC). Dr. Butler presently serves as President of the American Counseling Association (2021-2022) and is an ACA Fellow. Dr. Butler formerly served the University of Central Florida as the Interim Chief Equity, Inclusion and Diversity Officer and is a National Association of Chief Diversity Officer in Higher Education Fellow (2020-2021). In March of 2020, Dr. Butler was selected as a Fellow within the National Association of Chief Diversity Officer in Higher Education's Chief Diversity Officer Fellows Program (NADOHE-CDOFP). He is a 2020 – 2021 cohort (C-7) member. The professional leadership program mentors new and early career Chief Diversity Officers. Dr. Butler was also recently promoted to Professor of Counselor Education at the University of Central Florida and has served as a Faculty Fellow for Inclusive Excellence within the Office of the Provost.

Dr. Butler presently serves as faculty advisor to CHI SIGMA IOTA International Honor Society (CSI), the Counselor Education Doctoral Student Organization (CEDSO), Project for Haiti Knights, and the National Association for the Advancement of Colored People (NAACP). He served as the Principal Investigator, for The High-Risk Delinquent and Dependent Child Educational Research Project: Situational Environmental Circumstances Mentoring Program (SEC), which was a partnership between the University of Central Florida and several Florida universities. This grant opportunity has transitioned into the UCF Young Knights Mentoring Project a program that supports students at Hungerford Elementary School in Eatonville, FL.

Also on the national level, Dr. Butler has served the Association for Multicultural Counseling and Development (AMCD) as the 2011 – 2012 President and ACA Governing Council Representative (2015 – 2018). He is a proud member of AMCD's Multicultural Counseling Competencies Revisions Committee which produced the Multicultural Social Justice Counseling Competencies (MSJCC). His research and academic interests lie in the areas of Multicultural and International Counseling, Social Justice, Mentoring, Counseling work as it relates specifically to African American males, Group Counseling, School Counseling, and Multicultural Supervision.

KEYNOTE SPEAKER

Joyce Marter



[Joyce Marter](#) has been a licensed psychotherapist for over twenty years and is the Founder of [Urban Balance](#), an outpatient mental health company with sixteen locations in six states. Marter is the Chief Brand Ambassador for [Refresh Mental Health](#) and has served several leadership positions in the counseling profession including Chair of the Midwest Region of the American Counseling Association, President of the Illinois Counseling Association, and two-terms as President of the Illinois Mental Health Association.

As a member of the National Speakers Association, Joyce Marter is a national keynote speaker and international corporate and continuing education trainer. She pens the [Mental Wealth](#) blog on Psychology Today and is routinely consulted as a mental health expert in the media, featured in such outlets as Forbes, The Wall Street Journal, CNN and MTV. She is the author of [The Financial Mindset Fix: A Mental Fitness Program for an Abundant Life](#) which was published by Sounds True in July of 2021 and will be also be published and distributed in Korea, China, Spain and Latin America.

KEYNOTE SPEAKER

Dr. Maranda Griffin



Dr. Maranda Griffin, LPC, LMHC, QS, BC-TMH has been described as the leader's leader, coach's coach, friend's friend, and champion's champion. Formally trained in Counselor Education, Counseling and Psychology, and Elementary Education. Dr. Griffin prides herself on helping agencies and individuals soar through her business, MG Consultation, LLC where she focuses primarily on coaching, counseling, and consultation. Her motto is I believe in people; I want to see people win!

In her many years of state service in behavioral health, she secured and administered grants that directly impacted substance abuse prevention and treatment services in the state of Alabama. At the community level, she has provided services in prisons, jails, not-for-profit community agencies, faith-based institutions, university counseling centers, and private practice to include telehealth. In higher education, she serves as Senior Director of Academic Residencies supporting face-to-face and virtual experiences for bachelor's, masters', and doctoral students. She proudly served our country for 22 years before retiring.

She is a former Chapter VII President and Miles Seymour recipient. She remains active in the profession and community through presentation, publication, and service. She is featured in a number of textbooks, course companion resources, and has edited two anthologies, *Armed and Dangerous: A Collection of Triumphant Testimonies* and the *A&D Workbook*.

ALCA ANNUAL CONFERENCE

Sessions Schedule with Locations

Tuesday, November 16, 2021

1:00 PM	Exhibit setup begins	Birmingham Ballrooms I, V, IX
3:00 PM - 5:00 PM	Conference Registration	Birmingham Ballroom Pre-Function Area
6:00 PM - 8:00 PM	ALCA Executive Council Meeting	Forum B
8:15 PM - 9:00 PM	President's Reception for Executive Council Sponsored by ACT	President's Suite Room #943 Westin Hotel

Wednesday, November 17, 2021

8:00 AM - 9:30 AM	Awards Breakfast Sponsor: Home Builders Association of Alabama Kory Boling, Representative Presiding: Shawndrika Cook & Laventrice Ridgeway, ALCA Awards Co-Chairs	Birmingham Ballroom XI & XII
7:30 AM - 4:00 PM	Conference Registration	Birmingham Ballroom Pre-Function Area
8:45 AM - 5:00 PM	Exhibits	Birmingham Ballrooms I, V, IX
10:00 AM - Noon	OPENING GENERAL SESSION	Birmingham Ballrooms III, IV, VII, VIII

Presiding: Dr. Yulanda Tyre, ALCA President
 Reflection: Dr. Tarmen Siaway, ALCA Current Issues Chair
 Pledge of Allegiance: Dr. Kelley Mautz, ALCA Research & Evaluation Chair
 Introduction of 2021-2022 Officers: Dr. Yulanda Tyre, ALCA President
 Recognition of Sponsors: Dr. Yulanda Tyre, ALCA President
 Recognition of Chapters: Dr. Yulanda Tyre, ALCA President
 Introduction of Keynote Speaker: Shawndrika Cook, 2020 Emerging Leader
 Keynote Speaker: Dr. S. Kent Butler, Jr., ACA President

1:30 PM - 4:30 PM	School Counselor Roundup: Presenters: Sean Stevens, Dr. Monica Mack, Cathy Lankford, Terri Coleman, Margaret Sharp, & Zach McCraw	Birmingham Ballroom XI & XII
1:45 PM - 3:00 PM	CONTENT SESSIONS	The Forum/East Mtg. Rooms
3:00 PM - 3:15 PM	Break Sponsor: Sheraton Hotel	Birmingham Ballroom Pre-Function Area
3:15 PM - 4:30 PM	CONTENT SESSIONS	The Forum / East Meeting Rooms
4:30 PM - 4:45 PM	Break –Sponsor: ALCA	Medical Forum

4:45 PM - 5:30 PM	ALCA Division/Affiliate Meetings	
	ALAADA	Forum E
	ALAAOC	Forum B
	ALACES	Forum C
	ALAMCD	Forum G
	ALAMFC	East G
	ALASERVIC	East I
	ALASGW	Forum F
	ALCCA	Forum A
	ALCDA	Forum H
	ALDARCA	Forum D
	ALGBTICAL	Forum I
	ALMHCA	East M
	ALSCA	Forum J-K
5:45 PM - 6:30 PM	Chapter/Division/Affiliate Presidents & Presidents-Elect Meeting	East Meeting Room E
5:45 PM - 6:30 PM	New Members & First Timers Celebration	East Meeting Room D
6:30 PM - 7:30 PM	School Counselor Reception Sponsor: Bryant-Jordan Scholarship Program	Alabama Sports Hall of Fame

Thursday, November 18, 2021

7:00 AM - 8:15 AM	Wexford Health Breakfast	Birmingham Ballroom XI & XII
7:30 AM - 3:00 PM	Conference Registration	Birmingham Ballroom Pre-Function Area
8:00 AM - 5:00 PM	Exhibits	Birmingham Ballrooms I, V, IX
8:30 AM - 10:15 AM	GENERAL SESSION	Birmingham Ballrooms III, IV, VII, VIII
	Presiding: Dr. Yulanda Tyre, ALCA President Recognition of Divisions/Affiliates: Dr. Yulanda Tyre, ALCA President Recognition of ALCA Past Presidents: Dr. Yulanda Tyre, ALCA President Introduction of Keynote Speaker: Dr. Laura Hodges, Chapter VII President Keynote Speaker: Joyce Marter	
10:15 AM - 10:30 AM	Break Sponsors: ALCA Chapters, Divisions & Affiliates	Birmingham Ballroom Pre-Function
10:30 AM - 11:30 AM	ALCA Retired Counselors Reception	President's Suite - Room 943 Westin
10:30 AM - 11:45 AM	CONTENT SESSIONS	The Forum/East Mtg. Rooms
11:45 AM - 1:00 PM	Graduate Student Reception	East Meeting Room D

11:45 AM - 1:15 PM	Division/Affiliate Luncheon ALSCA	Medical Forum K
1:30 PM - 3:30 PM	Graduate Student Poster Session Sponsor: Alabama Council on Compulsive Gambling	Birmingham Ballroom Pre-Function Area
1:30 PM - 2:45 PM	CONTENT SESSIONS	The Forum/East Mtg. Rooms
1:30 PM - 2:45 PM	LPC/ALC Roundup Presenters: Dr. Dwayne White, UAB, Dr. Keith Cates, ABEC Executive Director, Anna Barksdale, ABEC Chair	Medical Forum C
1:30 PM - 4:15 PM	New School Counselor Academy Presenters: Sean Stevens, Cathy Lankford, Dr, Monica Mack, ALSDE	Birmingham Ballroom III, IV, VII, and VIII
2:45 PM - 3:00 PM	Break Sponsors: ALCA Chapters, Divisions, & Affiliates	Medical Forum Area
3:00 PM - 4:15 PM	CONTENT SESSIONS	The Forum/East Mtg. Rooms
4:15 PM - 4:30 PM	Break	Birmingham Ballroom Pre-Function Area
4:30 PM - 5:45 PM	CONTENT SESSIONS	The Forum/East Mtg. Rooms
4:30 PM - 5:45 PM	ALCA Past-Presidents Reception	President's Suite Room 943 Westin Hotel
5:45 PM - 6:30 PM	Chapter Meetings/Receptions/Socials	
	Chapter I	Forum E
	Chapter II	Forum G
	Chapter III	Forum F
	Chapter IV	Forum A
	Chapter V	Forum C
	Chapter VI	Forum I
	Chapter VII	Forum B
	Chapter VIII	Forum H
	Chapter IX	Forum D
7:00 PM - Until	Dinner on Your Own	
8:30 PM - 11:00 PM	Celebration Dance Music: JAMM Theme: Re-"Groove"-inate Dress: 70s Attire Sponsored by Jacksonville State University Door prizes donated by ALCA Chapters/Divisions/Affiliates and Exhibitors	Birmingham Ballrooms III & IV

Friday, November 19, 2021

7:30 AM - 8:15 AM	Biscuit Breakfast Sponsor: Amridge University	Birmingham Ballroom Pre-Function Area
8:30 AM - 10:15 AM	BUSINESS & GENERAL SESSION ALCA Business Meeting Presiding: Dr. Yulanda Tyre, ALCA President Introduction of Speaker: Dr. Rodney Maiden Keynote Speaker: Dr. Maranda Griffin What's Coming in 2022: Dr. Jane Coleman, ALCA President-Elect Closing Comments: Dr. Yulanda Tyre, ALCA President	Birmingham Ballroom I, V, VII, IX
10:30 AM - 11:45 AM	CONTENT SESSIONS	The Medical Forum
Noon - 1:00 PM	ALCA Conference Committee Meeting	

2021 ALCA ANNUAL CONFERENCE

Your Conference Planner

TIME	WEDNESDAY November 17	THURSDAY November 18	FRIDAY November 19
7:00 AM		BREAKFAST	BREAKFAST
7:30 AM		7:00 - 8:15 AM	7:30 - 8:15 AM
8:00 AM	AWARDS		
8:30 AM	BREAKFAST	GENERAL SESSION	BUSINESS & GENERAL SESSION
9:00 AM	8:00 - 9:30 AM	8:30 AM	8:30 AM
9:30 AM		KEYNOTE SPEAKER:	KEYNOTE SPEAKER:
10:00 AM	OPENING	JOYCE MARTER	MARANDA GRIFFIN
10:30 AM	GENERAL SESSION 10:00 AM		
11:00 AM	KEYNOTE SPEAKER:		
11:30 AM	S. KENT BUTLER, JR.	GRADUATE STUDENT	
12:00 PM		RECEPTION	
12:30 PM		11:45 AM-1:00 PM	
1:00 PM			
1:30 PM			
2:00 PM			
2:30 PM			
3:00 PM			
3:30 PM			
4:00 PM			
4:30 PM	DIVISION/AFFILIATE MEETINGS		
5:00 PM	4:45 - 5:30 PM		
5:30 PM	NEW MEMBER/ FIRST TIMER	CHAPTER MEETINGS	
6:00 PM	CELEBRATION	5:45 PM	
6:30 PM	5:45 - 6:30 PM		
	SCHOOL COUNSELOR		
	RECEPTION		
8:30 PM	6:30 - 7:30 PM	DANCE	
11:00 PM			

ALCA COUNSELOR LOCATOR SERVICE

The Counselor Locator Service is designed to match clients who need services with qualified counselors by location and areas of practice through the use of a simple database search system.

The Alabama Counselor Locator Service is a client focused service. The service is contained in a database located on the ALCA website. It allows anyone to go into the database and locate the counseling service needed and then to determine the Alabama counselor who can provide this service. The program helps clients find the services needed and helps our counselors identify clients. It has been well received statewide.

The target audience is the prospective client. It is a service designed solely to help the person in need to identify someone reasonably close who is qualified to help with the perceived problem. A byproduct is that LPCs and others have a mechanism from ALCA which helps them identify prospective clients.

Evaluation has been made primarily with feedback from participants. Counselors are steadily requesting to be added to the Service. Feedback comes in the form of comments from these people stating how pleased they are with the service and what a wonderful concept it is. There are several obvious benefits. Probably the greatest is the ability for a client to locate the service needed easily and quickly. From the counselor standpoint it is an opportunity to promote awareness. The professionalism of delivery has also enhanced the counseling image.

To view the Counselor Locator Service go to www.alabamacounseling.org and click on "Counselor Locator Service."

ALCA Members

If you would like to be added to the Counselor Locator Service as a provider, email your information to Dr. Nancy Fox at alca@alabamacounseling.org.

ALCA Endowment Fund

If you want to honor someone, send a memorial, or just make a contribution, the ALCA Endowment Fund is perfect for you.

Through your contribution, you contribute to activities that support counseling.

As a service to our Endowment Fund contributors, we will send the appropriate acknowledgements.

ALCA Activities Calendar

ALCA maintains a comprehensive schedule of its activities and professional development opportunities on its website. Go to www.alamacounseling.org and click on "Activities Calendar" to see what is happening in Alabama counseling.

ALCA Professional Liability Insurance

In today's professional setting, perhaps nothing is more important than making sure you are protected in the event a client sues you.
You need professional liability insurance.

ALCA and the Healthcare Providers Service Organization (HPSO) offer an excellent national insurance policy to our ALCA members.

Contact

Dr. Nancy Fox
(205) 423-5989
alca@alamacounseling.org

Program/Content Session Selection Procedures

Each year comments like these are made: “Why don’t we have more content sessions for _____ division/affiliate?” or “Why do school counselors have so many sessions?” By learning the selection process for session proposals, those who wonder “Why?” will have their questions answered.

20% of the available content session slots are assigned to ALCA. By recognizing that the membership of ALCA share common interests in addition to the specifics of their division/affiliate memberships, the opportunity exists for developing ALCA membership identity. This year ALCA has one additional content session due to one of the keynote speakers presenting a content session in the ballroom area.

80% of the available content session slots are assigned to divisions/affiliates as determined by the following formula: the total number of slots assigned to divisions/affiliates multiplied by the percent of the total ALCA membership for that division/affiliate equals the number of programs selected for that division/affiliate. Any program slots not used by a division/affiliate are re-assigned to the ALCA allotment.

The Program Committee selects content sessions at a meeting convened by the ALCA Program Chair (President-Elect). A quorum is comprised of members present at the meeting. The Program Committee is composed of the ALCA Program Chair, the ALCA Fall Conference Chair and a representative from each division/affiliate. Each division/affiliate representative is appointed by the division/affiliate president. Look at the percentages below and you will understand how this works.

Percentages and Number of Slots for Selecting Annual Conference Content Sessions (2021)

Total # of slots is 99 (based on rooms available) ALCA
(General Interest) gets 20% = 19 slots

This leaves 80 slots to be assigned based on division percentages.

ALCCA	5%	5 slots
ALACES	5%	5 slots
ALAMCD	5%	5 slots
ALCDA	3%	3 slots
ALGBTICAL	5%	5 slots
ALASGW	2%	2 slots
ALASERVIC	4%	4 slots
ALDARCA	1%	2 slots
ALAMFC	4%	4 slots
ALAAOC	4%	4 slots
ALAADA	3%	3 slots
ALMHCA	13%	13 slots
ALSCA	26%	25 slots
		80 slots

$$80 + 19 = 99$$

Notice that content sessions of possible interest to other divisions/affiliates are an additional listing following the sponsored division

1. Inner Wealth: The Nurtured Heart Approach – Parents, Educators, and Therapists

Presenter: **Celeste Neil**, Ph.D., LPC-S, NCC, NCSC, ACS celestecneil@gmail.com
Location: Medical Forum H
Sponsor: ALACES, ALASGW, ALAMFC, ALMHCA, ALSCA

The Nurtured Heart Approach promotes positive relationships, capturing everyday moments truthfully and reflecting them to celebrate great decisions and judgement while never failing to enforce rules in a simple, powerfully effective way.

2. The Silent Burnout: The Effects of COVID 19 and Social Justice

Presenters: **Shawndrika Cook**, M.S, Ed.S, LPC shawndrikaLcook@gmail.com
Kaycee Colon Roberts, MS, CMHC, NCC kaycee.roberts@gmail.com
Tammy W Montgomery, Ph.D., APC, NCC, LPC tmontgomery@brighterdaybhcs.com
Location: Medical Forum A
Sponsor: ALAMCD

Discussion components that affect clinicians of color.

3. Ethical Dilemma in Fairy Tales: School and Mental Health Settings

Presenter: **Poppy Moon**, Ph.D, LPC, NCC pmoon@uwa.edu
Location: Medical Forum B
Sponsor: ALAMCD, ALCDA, ALASGW, ALMHCA, ALSCA

Princes, wicked witches, little people, and stepmothers. Fairy tales are a wealth of human interaction. Let's examine these tricky topics and how counselors can best serve diverse populations.

4. Having Purposeful Difficult Dialogues: Counselors Passionately Filling the Gaps!

Presenters: **S. Kent Butler, Ph.D.**

skbutler@counseling.org

Location: East Meeting Room M

Sponsor: ALCA

“Difficult Dialogues” empowers attendees to learn strategies that will help them facilitate courageous conversations, including how to create safe and brave spaces for students engaging in these powerful discussions. Matching counseling pedagogies to the needs and backgrounds of our students and clients and developing sensitivity to institutional barriers and prejudices that impinge upon different cultures. An open and honest guided discussion will provide attendees with an opportunity to share and process through their own personal narratives in relation to ethnicity and culture.

5. CBT in Group Work: An Overview of Theory and Practical Strategies

Presenters: **Brittney Barnett, LPC, NCC**
Christi Scroggins Jones, Ph.D, ALC

brb0066@auburn.edu
csjones@faulkner.edu

Location: Medical Forum C

Sponsor: ALCCA, ALASGW, ALAMFC, ALMHCA, ALSCA

Develop confidence in applying CBT theory in the group setting. This presentation will provide an introduction to CBT groups and practical strategies for conducting CBT groups based on current professional literature.

6. Strong in Broken Places: Infusing Spirituality in Clinical Techniques

Presenter: **Jared Hood, M.Ed., MTS, LPC-S**

jared.hoodlpc@gmail.com

Location: Medical Forum I

Sponsor: ALASERVIC, ALAMFC, ALACES

At our core, we are spiritual people! We search for meaning and purpose. Come learn how to expertly weave faith-based principles into everyday clinical practice. Empower clients that they can be STRONG in the broken places.

7. Diversity, Equity, and Inclusion in the Workplace

Presenter: **Latofia Parker, Ph. D, NCC, LPC, BC-TMH**

lparker12@montevallo.edu

Location: Medical Forum D

Sponsor: ALAMCD, ALCDA, ALDARCA, ALMHCA, ALACES

The purpose of this presentation is to discuss strategies to improve diversity, equity, and inclusion in the workplace in order to promote greater mental health among professional counselors.

8. Strengthening Resilience in Families with Transgenerational Trauma

Presenter: **Fanicy Sears, LPC, LMFT, NCC, BC-TMH**

emotiontherapy@outlook.com

Location: East Meeting Room C

Sponsor: ALAMFC

Define and explore drivers, risk factors and relevant interventions for families who experience Transgenerational Trauma.

9. Tokin and Chokin: Marijuana and Mental Health

Presenter: **Kezziah F McDaniel, Ed.D, LPC-S**

kmcdaniel3377@gmail.com

Location: East Meeting Room A

Sponsor: ALAAOC, ALCCA, ALAADA, ALMHCA, ALSCA

An examination of the benefits and disadvantages of the use of marijuana and its effects on the symptoms associated with various mental health disorders.

10. Aging as a Spiritual Journey

Presenter: **Glenda R Elliott, Ph.D., LPC-SC (Retired)**

elliottg@bellsouth.net

Location: East Meeting Room B

Sponsor: ALAADA, ALACES, ALASERVIC, ALAMFC, ALMHCA

Drawn from personal and professional experience, a framework will be provided for deepening and enriching the experience of aging within the context of a spiritual journey including the implications for the counseling relationship.

11. Attending to the Mother-Infant Relationship in Maternal Mental Health

Presenter: **Dallas Rabig, LPC, NCC, IMH-E**

dallas.rabig@ece.alabama.gov

Location: Medical Forum F

Sponsor: ALAMFC, ALAAOC, ALMHCA, ALACES

This presentation will cover the effects of perinatal mood disorder on the mother-infant relationship and interventions for providers.

12. Changing the Perspective about Trauma in Schools

Presenter: **Dawn Rayburn, Ed.S, LPC, NBCT, NCC**

dryburn05@gmail.com

Location: Medical Forum J

Sponsor: ALSCA

What is the impact of childhood trauma in schools, and what can be done? Presenting a brief case for how trauma impacts school performance and behaviors and a few research based solutions.

13. Implementing ASCA National Model and Earning Program of Distinction

Presenter: **Cindy Davis, M.S., NBCT** cindy.davis@knology.net

Location: Medical Forum G

Sponsor: ALSCA

Participants gain an understanding of new ASCA Model and application process for Alabama School Counseling Program of Distinction with an emphasis on student achievement, attendance and discipline. Handouts provided.

14. Shifting Our Perspective on Trauma and Adversity

Presenter: **Stephan Berry, Ph.D., LPC** stberry@troy.edu

Location: East Meeting Room G

Sponsor: ALSCA, ALACES, ALAMFC, ALAADA, ALMHCA, ALSCA

Significant numbers of students experience trauma. The latest research-based information on how past experiences shape students' identities and behaviors, and the best strategies for healing and growth are featured in this presentation.

15. My Child Won't Go To School! Understanding the Phenomenon of School Refusal

Presenter: **Deborah Grant, Ph.D, LPCS, NCC, CRC** drdebgrant@gmail.com

Location: East Meeting Room I

Sponsor: ALAMCD, ALCDA, ALGBTICAL, ALMHCA, ALSCA

This session will explore the many issues surrounding school refusal in children in grades K-12. The presenter will discuss the socioemotional aspects of school refusal syndrome and share counseling strategies to use.

Wednesday, November 17, 2021 - 1:30 pm – 4:30 pm

School Counselor Roundup

Location: Birmingham Ballroom XI and XII

Sponsor: ALSCA

1:30 – 2:30 pm

All Grade Levels

Sean Stevens, Program Coordinator

Cathy Lankford, Education Specialist

Dr. Monica Mack, Education Specialist

2:30 – 3:30 pm

Elementary Level

Terri Coleman, School Counselor

Trace Crossings Elementary School

3:30 – 4:30 pm

Secondary Level

Margaret Sharp, School Counselor

Daphne High School

Zach McCraw, School Counselor

Spanish Fort High School

Join professional school counselors from across the state in the review of current practices in school counseling. Creative ideas and techniques for the various levels of school counseling will be explored.

16. Vicarious Trauma and Provider Care

Presenter: **Stephen N, Finzo, Psy.D.**

Stephen.finzo@citizensmemorial.com

Location: Medical Forum F

Sponsor: ALCCA, ALACES, ALAMFC, ALAAOC, ALMHCA

Treating trauma survivors can be rewarding, but vicarious trauma can be debilitating for the clinician. This workshop will build self-intervention skills enhancing well-being and self-care.

17. University Utilization of Resources on Covid-19 and Mental Health

Presenters: **Heather Dorough Windham, M.Ed., NCC**
Elizabeth Brittany Dennis, M.Ed., ALC, NCC
Jamie Carney, Ph.D.

had0005@auburn.edu
ebd0004@auburn.edu
carnejs@auburn.edu

Location: Medical Forum H

Sponsor: ALCCA, ALACES, ALCDA, ALMHCA, ALSCA

Preliminary findings of a content analysis examining universities' resources provided to support mental health issues in response to Covid-19 will be addressed. Session will discuss components of policies, referrals/support services, and mental health needs.

18. Courageous Conversations in Counseling about Race: A Demonstration

Presenters: **Robyn Trippany Simmons, Ed.D., LPC-S, NCC, RPT-S**
Brandi Chamberlin, Ph.D.
Nivischi Edwards, Ph.D., LMHC, LPC, NCC, BC-TMH

rsimmons30@liberty.edu
bipowell@liberty.edu
nedwards10@libertyy.edu

Location: Medical Forum C

Sponsor: ALAMCD, ALASGW, ALASERVIC, ALMHCA, ALACES

This session explores the topic of cultural humility in the counseling relationship, including an introduction to the courageous conversations protocol. Presenters will model a courageous conversation about race

19. Working with LGBTQ+ Students in Schools: School Counselors as Advocates

Presenter: **Ashley Redondo**, Ed.S., LPC, NCC ashleyredondo@gmail.com

Location: East Meeting Room B

Sponsor: ALGBTICAL, ALSCA, ALMHCA, ALACES, ALAMCD

This presentation will review LGBTQ+ terminology, how to be an advocate for LGBTQ+ students in the school setting, and provide support resources for parents/families, teachers, and students.

20. A Home for the Homeless: Supporting Foster Care Youth in Faith Development

Presenter: **April Upshaw**, Ph.D., SLPC aupshaw44899@troy.edu

Location: Medical Forum G

Sponsor: ALASERVIC, ALDARCA, ALAMFC, ALAAOC, ALMHCA

Foster care graduates have higher rates of teen pregnancy, dropping out of school, under- or un- employment, homelessness, incarceration, and early death. Can facilitating a spiritual connection help and what are the ethical considerations?

21. Blow Off Some STEAM! Integrating STEAM in School Counseling K-12.

Presenters: **Ann Smith**, M. Ed. anndsmith67@gmail.com
Tina Runyan, M.S. in School Counseling runyantina@gmail.com

Location: East Meeting Room A

Sponsor: ALSCA, ALCCA, ALCDA, ALDARCA

Do your students love STEAM activities? This engaging “Make and Take” session is designed for P-12 School Counselors that want to integrate STEAM learning into their program.

22. Researching Creative & Artistic Approaches to Counseling Supervision

Presenters: **Poppy Moon**, Ph. D, LPC, NCC pmoon@uwa.edu
Nisha Warbington, Ph. D, LPC, LPC-S, NC nwarbington@UWA.edu

Location: Medical Forum B

Sponsor: ALACES, ALAMCD, ALASERVIC, ALMHCA, ALSCA

Using art in supervision provides a method for counselors in training to develop self-awareness and professional growth. It is a way to examine one's self while learning techniques that can be used in clinical settings.

23. Training School Counselors in Family Systems Theory

Presenters: **Shannon McCarthy**, Ph.D smcc@uab.edu
Dayna Watson, Ph.D watsondm@uab.edu

Location: Medical Forum D

Sponsor: ALACES, ALAMFC, ALSCA

This presentation will discuss the rationale for training school counselors in Family Systems Theory (FST), specific concepts of FST that are valuable in school environments, and one strategy used at UAB for facilitating this training.

24. Discovering Self with Emotional Intelligence

Presenter: **Tonya Hillman**, M.S., LPC-S, NCC tonyahillman@hotmail.com

Location: East Meeting Room I

Sponsor: ALCCA, ALACES, ALAMCD, ALCDA, ALASGW, ALASERVIC

Attendees will learn multiple aspects of emotional intelligence and how it affects counselors. Through application exercises, emotional intelligence will be defined, applied to our daily lives, and how we cope emotionally in a stressful situation.

25. Addressing P&I Settings for Atypical/Typical Counseling Students

Presenters: **Mary Kathryn Fletcher, M.S.** maryfkathryn@gmail.com
Michael Azar, M.S. razar@troy.edu
Lovietta McCoy, M.S. lmccoy@troy.edu

Location: East Meeting Room C

Sponsor: ALACES, ALAMCD, ALCDA, ALDARCA, ALMHCA

This presentation will address practicum and internship settings for typical and atypical students. This presentation aims to help students, counselor educators, and site supervisors collaboratively work together to form a seamless process in counseling.

26. Finding Flexibility Through Gaming

Presenter: **Stephen Killen, LPC** killencac@gmail.com

Location: Medical Forum I

In this collaborative workshop we will discuss and demonstrate how various board games can be used to increase psychological flexibility using the ACT framework. The discussion will center on adolescent populations.

27. Classroom to Clinic: ADHD and Other Neurodevelopmental Disorders

Presenters: **Monica J Peak, ALC, NCC** m@monicaj.com

Location: East Meeting Room G

Sponsor: ALMHCA, ALSCA

A panel discussion with a parent, mental health counselor, teacher, and school counselor. Each panel member will discuss the topic from their perspective and experience followed by a time of Questions & Answers.

28. Thinking Theoretically: Counseling Theories for Children and Adolescents

Presenter: **Daniel Birdsong**, Ed.D, LPC, NCC, NCSC

danielbirdsong@icloud.com

Location: Medical Forum A

Sponsor: ALAMFC, ALMHCA, ALSCA, ALACES

This session will review major counseling theories shown effective in working with children and adolescents. Techniques, practical applications, and resources will be highlighted.

29. Best Practices in School Crisis Planning

Presenters: **Stephan Berry**, Ph.D. LPC
Laura Hodges, Ph.D., LPC-S, ACS

sberry143@sbcglobal.net
lhodges154803@troy.edu

Location: Medical Forum J

Sponsor: ALACES, ALASGW, ALAMFC, ALMHCA, ALSCA

Crisis preparation is a fundamental principle in crisis management. This session will focus on how school and mental health counselors can create effective crisis management plans or improve the crisis management plans for their school and district.

30. Coming Out of COVID: Getting Our Students Back on Track

Presenter: **Kelli Parrish Muncher**, Ed.S.

kelli.muncher@mps.k12.al.us

Location: East Meeting Room M

Sponsor: ALSCA

The COVID19 pandemic will haunt our students for years. Along with success stories from 2020-21, we must help the students that struggled with hybrid learning so that they still have the same admission chances as they did at the start of 2020.

31. Jesus, Be the Prozac!

Presenter: **Kezziah F McDaniel**, Ed.D., LPC-S

kmcdaniel3377@gmail.com

Location: Medical Forum I

Sponsor: ALAMCD, ALASERVIC

A brief examination of the history of spiritual foundations in the African American community and how to effectively incorporate this belief system into the treatment of mental health.

32. Ordinary to Extraordinary Living

Presenter: **Stephen N. Finzo**, Psych.D.

stephen.finzo@citizensmemorial.com

Location: Medical Forum F

Sponsor: ALCCA, ALACES, ALAMFC, ALAAOC, ALMHCA

Exiting the pandemic successfully requires beyond normalcy and ordinary. Living toward your extraordinary extends from the inner-development of knowing who you are and the ability of approaching others from the perspective of life-meaning.

33. 2020 Reflections of Advocacy by Black Counselors and Counselor Educators

Presenter: **Latonya Graham**, Ph.D., NCC, LPC (AL), LCMHCS (NC)

dr.lmgraham@gmail.com

Location: East Meeting Room G

Sponsor: ALAMCD, ALMHCA, ALCCA, ALACES

This presentation discusses the process of founding a collective of Black counselors and counselor educators leading the way for immediate action for equity, support, agency, and protection for current and incoming counseling graduate students.

34. "Black Women's Mental Health: Considerations for Counselors."

Presenters: **Astra Barkley, M.S., LPC**
Chippewa M. Thomas, PhD

azb0185@auburn.edu
thomas07@auburn.edu

Location: Medical Forum D

Sponsor: ALAMCD, ALAMFC, ALMHCA, ALACES

This session will highlight useful information for counselors working with Black/African-American women receiving mental health services.

35. Trauma and Diversity in the Career Construction Interview

Presenters: **Kevin B. Stoltz, Ph.D., NCC**
Andrea Hunt, Ph.D.

kbstoltz59@gmail.com
ahunt3@una.edu

Location: Medical Forum I

Sponsor: ALCDA, ALGBTICAL, ALMHCA, ALSCA, ALCCA, ALACES

This session provides suggestions for integrating trauma-focused counseling and diversity considerations into the Career Construction Interview.

36. Cultural Competence: How to Become a Culturally competent Clinician

Presenter: **Tarmen Siaway, Ph.D., LPC-S NCC**

tarmensiaway@yahoo.com

Location: Medical Forum J

Sponsor: ALCCA, ALACES, ALGBTICAL, ALDARCA, ALMHCA

The purpose of this workshop will be to help counselors develop their awareness and skills regarding cultural competence in practice.

37. The Pandemic within a Pandemic: Opioid Overdoses and Strategies for Helpers

Presenter: **Zach Ludwig, LPC-S** ziludwig21@gmail.com

Location: Medical Forum G

Sponsor: ALAAOC, ALMHCA, ALACES, ALASGW, ALDARCA

This course explores the continuing rise of opioid overdoses and role of the COVID-19 pandemic in substance use disorder progression. Learner will discuss role of MAT, overdose-reversal, and necessity of individual and community intervention.

38. Creating a Mentally Healthy Practice: Structuring Your Caseload

Presenters: **Robyn Simmons, Ed.D., LPC-S, NCC, RPT-S** rsimmons30@liberty.edu
Kristy Ford, Ph.D., LMHC, NCC kford27@liberty.edu
Stacey Lilley, Ph.D., LPC-S, NCC slilley@liberty.edu

Location: Medical Forum C

Sponsor: ALMHCA

Attending to counselor self-care and practice management is imperative for the mental health of the counselor. This presentation will identify consideration and practices for most effective counselor functioning and wellness.

39. Mandatory Mental Fitness-Creating Wellness for Law Enforcement Officers

Presenters: **Margaret A. Taylor, Ph.D., LPC-S, NCC** barnema@auburn.edu
Joanna Collins, APC jmh0224@auburn.edu

Location: East Meeting Room B

Sponsor: ALMHCA, ALAMFC, ALACES

An unhealthy officer poses a risk to himself, his fellow officers and the community. Mental health services must be implemented to prevent incidents from occurring rather than attending to damage that has already taken place.

40. Understanding How to Work with Survivors & Perpetrators of Sexual Violence

Presenters: **Jessica Tyler, Ph.D., LPC-S, NCC, BC-TMH** jim0001@auburn.edu
Rachael Estes, M.Ed, ALC, NCC rfe0001@auburn.edu

Location: East Meeting Room A

Sponsor: ALACES, ALAAOC, ALMHCA

Sexual violence is a form of lived trauma worldwide; it is crucial to understand how to treat these distorted mental frameworks. This presentation highlights strategies from TF-CBT, ACT, and other trauma-informed approaches to treat survivors and perpetrators.

41. Stick 'em Up: The Use of Aggressive Toys in School-Based Play Therapy

Presenters: **Amy P. Davis, Ph.D., NCC** apdavis@una.edu

Location: East Meeting Room M

Sponsor: ALSCA, ALMHCA

Play is the language of children and toys are the words. In schools, some policies exclude aggressive toys such as weapons. The presenters will discuss benefits, concerns, and strategies related to utilizing aggressive toys in school settings.

42. Fostering Hope: The Counselor's Role in the Foster Care System

Presenter: **Antonia C. Hill, M.A., ALC** counselorantonia@gmail.com

Location: East Meeting Room I

Sponsor: ALMHCA

Exploring the roles mental health counselors play in group homes, residential treatment facilities, and the communities that foster children; including real-life accounts from counselors at varying levels of expertise, supported by evidence-based research

43. Telemental Health Counseling: Ethical & Legal Issues

Presenter: **Celeste C. Neil, Ph.D., LPC-S, NCC, NCSC, ACS, BC-TMH, RPT-S** celestecneil@gmail.com

Location: East Meeting Room C

Sponsor: ALACES, ALASGW, ALAMFC, ALMHCA, ALSCA

The coronavirus pandemic forced many counselors to offer telemental health services to their clients. Legal and ethical issues of telemental health in counseling will be explored. Risks, benefits, and adjustments will also be discussed.

44. Working with Children and Families that Experience Racial Trauma.

Presenter: **Tylon Crook, NCC** tcrook@liberty.edu

Location: Medical Forum B

Sponsor: ALAMCD, ALAMFC, ALMHCA

This presentation focuses on highlighting racial trauma experienced within racial minority communities. Strategies and interventions will be put forward to help mental health counselors address issues of racial trauma presented by clients.

45. The Alabama Board of Examiners in Counseling: Changes and Updates

Presenters: **Keith Cates, Ph.D., LPC-S (AL), NCC, ACS, BC-TMH, IMH-E** keith.cates@abec.alabama.gov
Anna J. Barksdale, M.A., LPC-S, NCC annajbarksdale@gmail.com

Location: Medical Forum A

Sponsor: ALACES, ALAMFC, ALSCA

The ABEC's Chair and Executive Director will discuss the status of ABEC, including what ABEC has changed, what we're doing, and what is coming. A short presentation will be followed by a Q&A with the audience.

46. Let's Broach: Addressing Client-Counselor Differences to Improve Therapy

Presenters: **Jennifer Guffin**, M.Ed., ALC, NCC
Astra Barkley, MS, LPC
Joanna Collins, APC

jcp0099@auburn.edu
azb0185@auburn.edu
jmh0224@auburn.edu

Location: East Meeting Room I

Sponsor: ALAMCD, ALASERVIC

Clients are more likely to return to sessions when you are willing and able to address differences you have like race, gender, or religion. Learn how to effectively broach differences to ensure better care.

47. Hate No Longer Lives Here

Presenter: **Gabrielle Brundidge**, Ed.S.

gsbrundidge@gmail.com

Location: East Meeting Room G

Sponsor: ALAMCD, ALGBTICAL, ALDARCA, ALMHCA, ALSCA

No Place for Hate is a program sponsored by the Anti-Defamation League. With public displays of hate on the rise, it is more important than ever for schools to commit to programs that clearly define expectations in behavior for all members of the community.

48. Anxiety! Practical Treatment Interventions

Presenter: **Richard Yoakum**, M.S., LPC-S

ryoakum@samford.edu

Location: Medical Forum J

Sponsor: ALCCA, ALACES

Let's talk about how we can help our clients cope with anxiety. We will discuss client thoughts, feelings, behaviors and beliefs. Sounds like CBT to me!

49. Gatekeeping and Remediation in Post-Graduate Supervision

Presenter: **Dorothy Moore, LPC, ACS (VA)**

dorothy.moore@waldenu.edu

Location: Medical Forum I

Sponsor: ALACES

The presentation will explore the current post-graduate supervision process and broaden awareness toward post-graduate supervision.

50. Bridging the Gap Between the Black Church and the Mental Health Community

Presenter: **Antonia C. Hill, M.A., ALC**

counselorantonia@gmail.com

Location: East Meeting Room A

Sponsor: ALAMCD, ALASERVIC

Exploring the history of the Black Church as a beacon of hope for the African American Community and faith-based counseling interventions to address toxic stress stemming from being Black in America.

51. Leadership Development: Celebrating Counselors

Presenter: **Monica Motley, Ph. D.**

Alicia Richardson, M.A., LPC

Shawndrika Cook, M.S, Ed.S, LPC

drmmotley@gmail.com

heartofthemattercounseling@yahoo.com

shawndrikaLcook@gmail.com

Location: East Meeting Room B

Sponsor: ALCA

Are you a new member to the Alabama Counseling Association? Are you interested in leadership opportunities? If you are, this session is for you! This interactive session will provide you with tips on how to get more involved with your chapter, division or affiliate counseling group.

52. Neuroscience in Counseling: The Polyvagal Theory & Trauma

Presenter: **Dr. Celeste C. Neil**, Ph.D., LPC-S, NCC, NCSC, ACS, BC-TMH, RPT-S celestecneil@gmail.com

Location: East Meeting Room C

Sponsor: ALASGW, ALAMFC, ALMHCA, ALSCA, ALACES

Dr. Stephen Porges' Polyvagal Theory transformed the way we view trauma. Neuroception explains how our nervous system functions to keep us safe. Interventions including participant involvement for trauma therapy will be explored.

53. The Challenges of Foster Care Involvement and Facing Adulthood Alone

Presenter: **April Upshaw**, Ph.D., SLPC aupshaw44899@troy.edu

Location: Medical Forum F

Sponsor: ALAMFC, ALAAOC, ALMHCA, ALSCA, ALACES

Foster care graduates age-out with little support and often face dismal outcomes, even early death. Which sub-groups of foster care graduates are high risk? What are the questions Counselors should be asking all of their clients?

54. Cocaine, Opioids, & Hate Crimes: Effects of White Leniency on Mental Health

Presenter: **Latonya Graham**, Ph.D., NCC, LPC (AL), LCMHCS (NC) dr.lmgraham@gmail.com

Location: East Meeting Room M

Sponsor: ALAMCD, ALCCA, ALACES, ALMHCA

This presentation will explore the historical patterns related to racial disparities in our criminal justice system and provide timely insight into the role of mental health providers in the rehabilitation and treatment of convicted white supremacists.

55. Black Moms Be Like . . .

Presenters: **Theresa Steele Mitchell, M.S., LMFT**
Mahalian Boykin, Ed.D., LPC

theresa.mitchell@sequelyouthservices.com
mahalian.boykin@sequelyouthservices.com

Location: Medical Forum H

Sponsor: ALAMCD, ALAMFC

This presentation will explore perceptions of Black Women in the family & popular culture, as well as, potential influences on generational & cultural patterns. Parenting styles & effective family therapy interventions will also be discussed.

56. Experiential Counseling in the Classroom

Presenter: **Lisa Butler, Ed.S., LPC-S, NCC**
Billie Miller, MS

lisakaybutler@gmail.com
bmiller@blountboe.net

Location: Medical Forum C

Sponsor: ALSCA

A look from both elementary and high school counselor perspectives. Will define experiential learning, describe steps involved in designing learning activities in classroom counseling lessons, and will provide sample lessons to use in your own program.

57. How to Build and Manage a College Counseling Program, Step by Step Approach

Presenter: **Amy Smith, Ed.S.**

amy.smith@pellcityschools.net

Location: Medical Forum D

Sponsor: ALACES, ALSCA

How to help students succeed at the secondary level can be overwhelming for school counselors. A simple step by step approach to develop a research based comprehensive college counseling program.

58. Conflict Resolution: I am a Problem Solver!

Presenters: **Terri Coleman**, M.Ed., M.S., Ed.S.
Ericka Leonard, M.Ed, M.S., NBCT

tcoleman@hoover.k12.al.us
eleonard@hoover.k12.al.us

Location: Medical Forum G

Sponsor: ALMHCA, ALSCA

To provide elementary and middle school counselors with tools to help students identify the source of the conflict and be equipped with the necessary steps to problem solve in and outside of school.

59. Ethics in Animal Assisted Therapy

Presenter: **Megan C. W. Bridges**, M.S., AADC

megancwbridges@outlook.com

Location: Medical Forum B

Sponsor: ALASERVIC, ALAMFC, ALAAOC, ALMHCA, ALSCA

Examination of the legal and ethical guidelines in place to protect both client welfare as well as the well-being of the animal co-therapist in animal assisted therapy.

Thursday, November 18, 2021 -- 1:30 pm – 2:45 pm

LPC/ALC Roundup

Presenters: **Dwayne White, Ph.D., LPC, NCC, CCMHC**
whitedm@uab.edu

Keith Cates, Ph.D., LPC-S (AL), NCC, ACS, BC-TMH, IMH-E
keith.cates@abec.alabama.gov

Anna J. Barksdale, M.A., LPC-S, NCC
anna.barksdale@abec.alabama.gov

Location: Medical Forum A

Sponsor: ALCA

Welcome to the 2021 LPC/ALC Roundup! This special session is open to all Licensed Professional Counselors (LPCs) and Associate Licensed Counselors (ALCs). This year we are excited to welcome ALCs to the Roundup and welcome back LPCs. We want to work together to support your professional growth and development so that we can better meet the goals of every counselor which include quality, and safe care of our clients.

This session will provide information and updates on best practices for telehealth counseling services and related topics. The ABEC Chair and Executive Director will discuss the status of ABEC, including what ABEC has changed, what we're doing, and what is coming. ALMHCA's goal for this session is to provide skills and resources needed for counselors to thrive in today's world.

Wednesday, November 18, 2019 1:30 pm-4:30 pm

New School Counselor Academy

Presenters: Sean Stevens, ALSDE Program Coordinator, Instructional Services
Monica Mack, Ph.D., ALSDE Counseling and Guidance Specialist
Cathy Lankford, ALSDE Counseling and Guidance Specialist

Location: Ballroom III, IV, VII, VIII

Sponsor: ALSCA & ALSDE

Professional School Counselors new to the profession often question what they need to know during their first few years on the job. Every new school counselor should feel confident they understand their roles and are equipped with best practices regarding full implementation of the comprehensive school counseling and guidance program. This session has been designated as one of the professional development opportunities to meet state certification requirements for new Alabama School Counselors (less than three years of experiences).

60. The Basics of Exposure and Response Prevention Therapy

Presenter: **Whitney Jerkins, LPC, NCC**

whitneyyy2@gmail.com

Location: East Meeting Room I

Sponsor: ALMHCA

Learn the basics of ERP therapy and why ERP is considered the new “gold standard” treatment for Anxiety and OCD. Challenge yourself and improve the way you currently work with your anxiety and OCD patients.

61. Implementing Trauma Informed Supervision

Presenter: **Margaret Taylor, Ph.D., LPC-S, NCC**

barnema@auburn.edu

Location: Medical Forum C

Sponsor: ALACES, ALAMFC, ALMHCA, ALSCA

Research studies have indicated trauma informed supervision can serve as a protective factor against emotional exhaustion, burnout and turnover. Preventing burnout, vicarious trauma and secondary trauma can decrease harm to clients (Cieslak et al, 2014).

62. How to Be an Ally and Not an Annoyance

Presenter: **Priscilla Wilson, Ph.D., LPC**

pgwilson@jsu.edu

Location: Medical Forum H

Sponsor: ALAMCD

With the deaths of George Floyd, Ahmaud Arbery, and Breonna Taylor, the summer of 2020 was marked with an international Civil Rights Movement with supporters from different demographics. I will discuss the dos and don'ts of being a White ally.

63. Trauma-Informed Care: Working with Trauma-Related and Survivor Guilt

Presenters: **Jessica Melendez Tyler**, Ph.D., LPC-S, BC-TMH, NCC jim0001@auburn.edu
Heather Delgado, Ph.D., LPCA, NCC hnm0030@auburn.edu

Location: Medical Forum A

Sponsor: ALAMCD, ALGBTICAL, ALMHCA, ALACES

As trauma becomes interwoven into life, it is imperative to amplify clinical skills in working with trauma-related and survivor guilt. This presentation will discuss sources of guilt and grief, and how this guilt impacts recovery.

64. The Best Predictor of Successful ADHD Treatment: EEP

Presenters: **Monica J Peak**, ALC, NCC m@monicaj.com

Location: East Meeting Room A

Sponsor: ALMHCA, ALSCA

Engaged and Empowered Parents (EEP) are the best predictor of successful ADHD treatment. So, we want to encourage and collaborate with EEPs. We also must recognize the greater needs that exist for our students or clients who are without such support.

65. Becoming Iconic: 10 Lessons from ALCA Counseling Icons

Presenters: **Chris DaSambiagio-Moore**, Ph.D., LPC, NCC csdmoore@una.edu
Joy Burnham, Ph.D., LPC, NCC jburnham@ua.edu

Location: East Meeting Room B

Sponsor: ALACES, ALMHCA, ALSCA

ALCA Icons are visionary leaders who taught us, mentored us, and steered us to new heights in the State. With historical insight from ten ALCA Icon interviews, this presentation offers valuable lessons for current counselors.

66. School and Career Counselors: Essential to Ending Generational Foster Care

Presenters: **April Upshaw, Ph.D., SLPC**

aupshaw44899@troy.edu

Location: Medical Forum F

Sponsor: ALCCA, ALCDA, ALDARCA, ALAMFC, ALSCA

Statistically, foster care graduates are at-risk for poverty, incarceration, and even early death. . Are we addressing the needs of this population? What are the ethics involved? How can school and career counselors help to end the generational cycle?

67. Helping Counselors Deal with the New COVID-19 Normal

Presenter: **Necoal Driver, Ph.D., LPC**

ndriver22670@troy.edu

Location: Medical Forum D

Sponsor: ALAMCD, ALCDA, ALDARCA, ALAMFC, ALMHCA

The COVID-19 Pandemic brought about stress and tension for many individuals. The New Normal however is bringing forth new challenges for some. This presentation will explore intervention strategies to help counselors continue to manage their mental health.

68. The Aftermath of COVID-19: Addressing Client Care through a Loss Lens

Presenters: **Kaycee Colon Roberts, M.S., CMHC, NCC**
Astra Barkley, M.S., LPC

kcr0035@auburn.edu
Azb0185@auburn.edu

Location: Medical Forum G

Sponsor: ALCCA, ALACES, ALAMFC, ALMHCA, ALSCA

The COVID-19 pandemic left many with not only the loss of loved ones but also non-death related losses. This session discusses addressing client care through a loss lens.

69. Reclaiming Spirit through Creativity

Presenters: **Quinn M. Pearson**, Ph.D., LPC
Jaina Glaze, M.A., NCC
Candace Robinson, M.A., NCC, PCMHT

qmpearson@una.edu
Rev.JainaAnderson@gmail.com
candacerobinson919@gmail.com

Location: Medical Forum I

Sponsor: ALASERVIC, ALAADA, ALMHCA, ALACES, ALASGW

Presenters will provide strategies and techniques for accessing meaning, hope, and joy through creative modalities: art, poetry, prose, and more. Participants will engage in creative activities that can be applied to counselor and client self-care.

70. Cultural Competency in Assessment and Diagnosis

Presenters: **J.C. Ausmus**, M.S., M.A.
Elizabeth Brittany Dennis

jza0079@auburn.edu
ebd0004@auburn.edu

Location: East Meeting Room G

Sponsor: ALAMCD, ALMHCA, ALCCA, ALACES

This presentation will focus on cultural competency in assessment. Definition of cultural validity in assessment, changes in the DSM-5, what a cultural formulation interview is, diversity sensitive assessment and diagnosis will be discussed.

71. 21st Century Career Counseling in Schools

Presenters: **Amy P. Davis**, Ph.D., NCC
Kevin B. Stoltz, Ph.D., ACS, NCC

apdavis@una.edu
kstoltz@una.edu

Location: Medical Forum B

Sponsor: ALCDA, ALSCA

Shift your school from 20th to 21st century career counseling using card sorts, career decision making models, career assessments, and individual career counseling. Many tools, techniques, and resources will be shared.

72. Building an Anti-Racist School Counseling Program

Presenter: **Tylon Crook, NCC**

tcrook@liberty.edu

Location: East Meeting Room C

Sponsor: ALAMCD, ALSCA

This presentation will focus on addressing social justice issues in the K-12 setting by fostering an anti-racist school counseling program. Anti-racist strategies rooted in the academic, social/emotional, and career development of students will be put forward.

73. Telehealth: Pre/Post Pandemic and Where Do We Go From Here

Presenters: **Shannon Treadwell, NCC, ALC**
LaShunda Wilson, ALC

shannontreadwell@gmail.com
shun.matthews@gmail.com

Location: Medical Forum J

Sponsor: ALMHCA, ALSCA

This presentation explores use of telehealth pre and post Covid-19 pandemic to see what we have learned about use of telehealth as well as exploring the accessibility to services it provided and will telehealth be firmly established as a treatment option.

74. Unveiled losses in Narcissistic Relationships

Presenter: **Doris Vaughans, LPC, NCC, TMHC**

dorisvaughans@yahoo.com

Location: East Meeting Room M

Sponsor: ALAMCD, ALASERVIC, ALAMFC, ALAAOC, ALMHCA

Losses are commonplace in narcissistic relationships. Vignette: Counseling clients impacted by narcissism.

75. Parenting as a Professional Counselor- Creating A Work/Life Balance

Presenters: **Nisha Warbington**, Ph.D., LPC-S, NCC nwarbington@uwa.edu
Deborah Dillon Grant, Ph.D., LPC-S, NCC, CRC dgrant@uwa.edu
Paul Hard, PhD, LPC-S, NCC pfhard@gmail.com
Jared Hood, M.Ed., MTS, LPC-S jared.hoodlpc@gmail.com

Location: East Meeting Room B

Sponsor: ALASGW, ALAMFC, ALMHCA, ALSCA

This session will be a panel discussion with professional counselors who will share their experiences as both counselors and full time parents. The focus will be on sharing tips for work life balance and living your best life as a parent and a counselor.

76. Ready to Play- Helping High School Athletes Achieve

Presenters: **Ann Smith**, M. Ed. anndsmith67@gmail.com
Coach Bill Smith, M. Ed wsmith5@bhm.k12.al.us

Location: East Meeting Room G

Sponsor: ALCCA, ALAMCD, ALCDA, ALSCA

Husband and Wife/ Coach and Counselor team explore best practices for High School Athletic Coaches and School Counselors to work together to benefit the student athlete.

77. An Introduction to Neurofeedback in Counseling

Presenter: **Michelle Essary**, M.A., LPC, BCN michelle@fullwellneurofeedback.com

Location: East Meeting Room C

Sponsor: ALCCA, ALCDA, ALAMFC, ALMHCA, ALSCA

The program will present the history and basic concepts of EEG based neurofeedback and how it can be used in conjunction with counseling for greater symptom reduction and change potential in clients.

78. Suicide Grief: Dispelling Misconceptions to Reduce Suicide Death Stigma

Presenters: **Belinda Kock**, M.Ed., NCC, CT

free2grieve@gmail.com

Location: East Meeting Room A

Sponsor: ALASGW, ALASERVIC, ALAMFC, ALAADA, ALMHCA

Suicide survivors face a unique type of grief and are at a higher risk of complicated grief. Dispelling the most common misconceptions that suicide survivors face is one way to break the stigma of suicide.

79. Supportive Counseling in a Rural Microcosm: Benefits and Challenges

Presenter: **C. Tate-Braxton Barker**, Ed.D, M.Ed, MS/LPC

dbarker4863@charter.net

Location: East Meeting Room M

Sponsor: ALCDA, ALASERVIC, ALAMFC, ALMHCA, ALSCA

This presentation looks at the benefits and challenges of counseling in a rural work setting.

80. A Better Way Forward: Self-Care & Replenishing for the Helping Professional

Presenter: **Cara Blakes**, LPC, NCC, BC-TMH

blakescara@gmail.com

Location: Medical Forum H

Sponsor: ALACES, ALAMCD, ALASERVIC, ALAMFC, ALMHCA

In light of covid-19, instead of searching for a “new normal”, we will determine what “a better way forward” may mean for each of us now, by linking personal core values to personalized self-care plans.

81. Developmental Trauma: Conceptualizing Interventions for Children

Presenter: **Robyn Simmons**, Ed.D., LPC-S, NCC, RPT-S

rsimmons30@liberty.edu

Location: Medical Forum C

Sponsor: ALAMFC, ALMHCA, ALSCA

The focus of this presentation is to provide a deeper understanding of human growth and development in children, including healthy cognitive functioning and the impact of adverse child experiences on that functioning.

82. Unexpected Loss: PGD, Coping Strategies, and Therapeutic Approaches

Presenter: **Emma Quadlander**, M.S., ALC
Emma Victoria Taghon, M.S., NCC
Angelene Kendall, M.S.

elq0002@auburn.edu
evt0002@auburn.edu
ack0071@auburn.edu

Location: Medical Forum D

Sponsor: ALCCA, ALMHCA

Individuals bereaved by unexpected loss struggle with Prolonged Grief Disorder (PGD), utilize coping strategies different than those bereaved by natural loss, and can benefit from CBT and restorative retelling.

83. Creating a Space for Open Dialogue about CACREP-Awareness

Presenter: **V. Paige Zeiger**, Ph.D., LPC, NCC, BC-TMH

paiglang@yahoo.com

Location: Medical Forum I

Sponsor: ALACES, ALMHCA

This presentation highlights research exploring master's level counseling students' CACREP-awareness, how CACREP-awareness influences their program selection, and offer recommendations for its future use.

84. Ethical Considerations for the Substance Use Disorder Treatment Provider

Presenter: **Zach Ludwig**, LPC-S

ziludwig21@gmail.com

Location: Medical Forum A

Sponsor: ALACES, ALASGW, ALDARCA, ALAAOC, ALMHCA

This course explores common ethical dilemmas faced by providers working clients with substance use disorders. Examples of topics include: informed consent, professional boundaries, HIPAA, 42 CFR Part 2, and competency.

85. Polyvagal Theory and Bottom Up Approaches for Treating Trauma

Presenter: **Jessica Penot**, M.S., LPC, ADC

Jessica.penot@gmail.com

Location: East Meeting Room I

Sponsor: ALMHCA

The fundamentals of Polyvagal theory will be reviewed as well as the neurology behind bottom-up approaches to trauma treatment. This will be followed by demonstrations of treatment techniques including Porges Safe and Sound Method, yoga for trauma, etc.

86. Poverty and Trauma in the Classroom

Presenter: **Meagan Weaver**, Ed.S.

weaverme@marshallk12.org

Location: Medical Forum B

Discussion of the six hard-wired emotions, how to teach while we empower, and ways trauma and poverty are seen in the classroom. We will review the mass trauma experiences due to Covid-19 and its effects on the student population.

87. So, you're thinking about private practice?

Presenter: **Dana Hampson**, LPC-S, MBA

danahampson@yahoo.com

Location: Medical Forum J

Sponsor: ALACES, ALAMFC, ALMHCA

Let's talk about the bottom line information you should consider before making the leap into private practice. Hear from a seasoned practice owner and business consultant and leave feeling more confident and prepared!

88. Witnessing Violence Can Lead to Emotional Desentization in Young People

Location: **Tammy W Montgomery**, Ph.D., APC, NCC, LPC

tmontgomery@brighterdaybhcs.com

Location: Medical Forum F

Sponsor: ALAMCD, ALMHCA

When children and adolescents are eyewitnesses to IPV or physically victimized, these young people may be negatively affected for life. Learn how school and mental health counselors can prevent the cycle of IPV in children.

89. Providing Support and Understanding to Clients with Chronic Illness

Presenter: **Lindsay S Harrell**, M.S., LPC, NCC

les0084@auburn.edu

Location: Medical Forum I

Sponsor: ALDARCA, ALAMFC, ALMHCA

The purpose of this presentation is to provide guidance and information to counselors working with clients diagnosed and experiencing chronic illness. Counseling approaches, techniques, and Spoon Theory will be discussed.

90. Trauma Focused Cognitive Behavioral Therapy

Presenter: **Emma Quadlander, M.S., ALC**
Madeline LaPolla, M.Ed., NCC

elq002@auburn.edu
mzl0113@auburn.edu

Location: Medical Forum D

Sponsor: ALAMFC, ALMHCA

This presentation will cover the origins and session components of trauma-focused CBT to effectively treat children and adolescents struggling with trauma-related difficulties.

91. Moms Play Too!

Presenters: **Madalyn Tinia Caldwell, Ed.S., LPC, PHM-C**

mcaldwell@tsccenter.org

Location: Medical Forum G

Sponsor: ALMHCA

This session focuses on the use of play therapy in treating postpartum anxiety (PPA). Attendees will gain knowledge of risk factors and symptoms of PPA and play therapy interventions that are useful in the treatment of PPA.

92. Solution-Focused Brief Therapy

Presenter: **Stephen N. Finzo, Psy.D.**

Stephen.finzo@citizensmemorial.com

Location: Medical Forum B

Sponsor: ALMHCA

This training is designed to build the skills of the provider through an overview of the establishment and development of SFBT, its uses for appropriate populations, and the skills and nuances for application.

93. Expressive Counseling Interventions for Children and Adolescents

Presenters: **Hillary P Ellerman**, Ph.D, ALC, NCC
Lindsay S. Harrell, M.S., LPC, NCC

hpe0002@auburn.edu
es0084@auburn.edu

Location: Medical Forum C

Sponsor: ALACES, ALASGW, ALAMFC, ALMHCA, ALSCA

The purpose of this session is to provide examples of expressive and interactive interventions to use with children and adolescents. Sandtray, play therapy, bibliotherapy, and games will be discussed.

94. Families & School: Equipping Family Counselors to Work with School Systems

Presenter: **Dayna M Watson**, Ph.D.
Shannon McCarthy, Ph.D.

watsondm@uab.edu
smcc@uab.edu

Location: Medical Forum J

Sponsor: ALACES, ALAMFC

Counselors may consider education to be separate from their work with the family; however, systems theory reminds us that the family system's interaction with another system, like school, has a ripple effect on family functioning.

95. JUNG'S MAP OF THE SOUL 7: Persona, Shadow, Ego in the World of BTS

Presenter: **Melissa Werner**, Ph.D., LPC, Jungian Analyst

mwerner@bellsouth.net

Location: East Meeting Room A

Sponsor: ALCCA, ALACES, ALAMCD, ALGBTICAL, ALSCA

An overview of Jung's Map of the Soul and how the band BTS shares it with their 30 million followers. What is their message of caring, self-acceptance and the need for a positive mental health?

96. Living Well With Sickle Cell Disease

Presenters: **Linda J. M. Holloway**, Ed.D, NCC

lindahollowayspeak@gmail.com

Location: Medical Forum G

Sponsor: ALACES, ALAMCD, ALMHCA, ALSCA

This workshop is designed to share with the audience how the author uses the book- "Little Miss Linda Speaks about Sickle Cell Disease" to teach children how to treat and support other children her suffered from this dreaded illness.

97. Let the ALCA Ethics Committee Help You Make Your Wrong Right

Presenters: **ALCA Ethics Committee**

Location: Medical Forum A

Sponsor: ALCA

Please come join the ALCA Ethics Committee as we address “Hot Ethical Topics/Issues Moving Through Alabama”. Be prepared to share in conversation about ALCA’s ethical guidelines and other pressing ethical dynamics!

98. Career Satisfaction and Mental Well-Being among K-12 Professionals

Presenter: **Latofia Parker**, Ph.D., NCC, LPC, BC-TMH

lparker12@montevallo.edu

Location: Medical Forum F

Sponsor: ALACES, ALCDA, ALAADA, ALMHCA, ALSCA

The purpose of this presentation is to present preliminary data on a quantitative study investigating career satisfaction and mental well-being among K-12 professionals.

99. The A-Team for ADHD and Other Neurodevelopmental Disorders

Presenters: **Monica J Peak**, ALC, NCC

m@monicaj.com

Location: Medical Forum H

Sponsor: ALMHCA, ALSCA

Gold chains and a cargo van not required (but are optional). We will discuss the importance of clinical and school counselor collaboration along with other essential members in creating an A-Team to support students with ADHD and other NDDs.

ALABAMA COUNSELING ASSOCIATION

Mission Statement

To enhance human development throughout
the life span and to promote public confidence
and trust in the counseling profession



ALABAMA COUNSELING ASSOCIATION

Benefits of ALCA Membership

Outstanding Annual Conference
Ongoing Drive-In Workshops
Ongoing Opportunities for CEU Credits
The ALCA Journal, Refereed Professional Journal
The ALCA Facebook Page
Chapter, Division & Affiliate Newsletters
Chapter Division & Affiliate Facebook Pages/Websites
Affiliation with the American Counseling Association
Comprehensive Liability Insurance
Legislative Monitoring
Counseling Issues Advocacy
Centralized State Office
Liaison with Licensure Board
Administrative Advice from Executive Director
Free Legal Advice from Legal Counsel
Informative Website
Continuously Updated Listserv
Activities Calendar
Statewide Counselor Locator Service

ALABAMA COUNSELING ASSOCIATION

2021-2022 Leadership

Officers

President.....	Dr. Yulanda Tyre
President Elect	Dr. Jane Coleman
Past President.....	Jacques L. Austin
Secretary.....	Dr Griena Knight Davis
Treasurer.....	Lisa M. Patterson
Historian.....	Dr. Chris DaSambiagio-Moore
Parliamentarian.....	Richard Hester
Executive Director	Dr. Nancy Fox
Incoming Executive Director.....	Emily Rich

Chapter Presidents

Chapter I.....	Dr. Jennifer Todd
Chapter II.....	Lisa Butler
Chapter III.....	Andrea Gregg
Chapter IV	Shawndrika Cook
Chapter V.....	Torsten Dryden
Chapter V.....	Dr. Alice Jackson
Chapter VII.....	Dr. Laura Hodges
Chapter VIII.....	Darnesha Lewis
Chapter IX.....	Blaine Lipford

Division/Affiliate Presidents

ALACES	Dr. Brad Willis
ALAMCD.....	Michelle Crumbly
ALASGW	Brittney Barnett
ALCCA.....	Dr. Lola Johnston
ALDARCA	Dr. Shatoi Scott
ALMHCA.....	Krishula Edwards
ALSCA	Dr. Amy Upton
ALAMFC.....	Fancy Sears
ALCDA.....	Dr. Michele Eller
ALAAOC.....	Dr. E. Kelley Mautz
ALASERVIC.....	Dr. April Upshaw
ALAADA	Clinton Reeves
ALGBTICAL.....	Candace Bailey

Standing Committee Chairs

Awards & Resolutions (State).....	Shawndrika Cook
.....	Dr. Laventrice Ridgeway
Budget & Finance	Lisa M. Patterson
Bylaws.....	Richard Hester
Gov't & Professional Relations (State).....	Marjorie Baker
.....	Janis Braue
Ethics.....	Dr. Tammy Montgomery
Membership.....	Casey Lancaster
Program.....	Dr. Jane Coleman
Publications	Jacques L. Austin
Nominations & Elections	Jacques L. Austin
Professional Standards	Sheryl Smith
.....	Dr. Quinn Pearson
Publicity.....	Dr. Chris DaSambaggio-Moore

Special Committee Chairs

ALCA NBCC Coordinator.....	Dr. Debbie Grant
Leadership Chapters, Divisions, & Affiliates.....	Dr. Monica Mack
.....	Vincent D. Hinton
Endowment Fund	Dr. Ingie Burke Givens
Graduate Students	Vincent D. Hinton
.....	Dr. Latonya Graham
Hospitality.....	Carolyn J. Liggins
Current Issues.....	Dr. Tarmen Siaway
Leadership Development/Emerging Leader Program	Dr. Monica P. Motley
.....	Alicia Richardson
Strategic Planning.....	Jacques L. Austin
Research & Evaluation.....	Dr. E. Kelley Mautz
Professional Development	Nancy Fortner
Annual Conference	Dr. Necoal Driver
.....	Dr. Starrah G. Huffman
.....	Dr. Lynn Boyd

Special Functions

Alabama Board of Examiners in Counseling.....	Dr. Keith Cates
State Dept of Education Liaison.....	Sean Stevens
ACA Co-Liaisons	Dr. Thelma Robinson
.....	Dr. Doris Vaughans
Journal	Dr. Brad Willis
Retired Counselors Group	Judy Childress
Chi Sigma Iota Co-Liaisons.....	Dr. Robyn Simmons
.....	Dr. Dayna Watson
Circle of Presidents.....	Leslie N. Weaver-Martin
Ads & Exhibits.....	Jerri Lynn Morrow
Adaptive Needs Accommodations.....	Dr. Laventrice Ridgeway
Emerging Leader.....	Shawndrika Cook

ALABAMA COUNSELING ASSOCIATION



Chapters by County

Chapter I	Colbert, Cullman, Franklin, Lauderdale, Lawrence, Limestone, Morgan, Winston.
Chapter II	Blount, Jackson, Madison, Marshall.
Chapter III	Fayette, Greene, Hale, Lamar, Marion, Pickens, Sumter, Tuscaloosa, Walker.
Chapter IV	Jefferson, Shelby.
Chapter V	Calhoun, Cherokee, Cleburne, DeKalb, Etowah, St. Clair, Talladega.
Chapter VI	Autauga, Bibb, Butler, Chilton, Choctaw, Dallas, Lowndes, Marengo, Perry, Wilcox.
Chapter VII	Bullock, Chambers, Clay, Coosa, Elmore, Lee, Macon, Montgomery, Randolph, Russell, Tallapoosa.
Chapter VIII	Baldwin, Clarke, Conecuh, Escambia, Mobile, Monroe, Washington.
Chapter IX	Barbour, Coffee, Covington, Dale, Crenshaw, Geneva, Henry, Houston, Pike.

Divisions and Affiliates

ALCCA	– Alabama College Counseling Association: Serves professionals who are involved in counseling in the post-secondary education setting.
ALACES	– Alabama Association for Counselor Education and Supervision: Emphasizes the need for quality education and supervision of counselors in all work settings.
ALAMCD	– Alabama Association for Multicultural Counseling and Development: Develops programs specifically to improve ethnic and racial empathy and understanding.
ALCDA	– Alabama Career Development Association: Provides vital services to counselors and allied professionals working in schools, colleges, military services, correctional institutions, business, and community agencies.
ALGBTICAL	– Association for Lesbian, Gay, Bisexual and Transgender Issues in Counseling in Alabama serves as an educational resource for counselors regarding LGBT individuals and related issues.
ALASGW	– Alabama Association for Specialists in Group Work: Assists and furthers interests of children, youth, and adults by providing effective services through the group medium.
ALASERVIC	– Alabama Association for Spiritual, Ethical, and Religious Values in Counseling: Seeks to examine the roles of values, theological, philosophical, and ethical principles in counseling and personnel practices.
ALDARCA	– Alabama Division of the American Rehabilitation Counseling Association: Promotes the welfare of people with disabilities through rehabilitation counseling research, education and practice.
ALAMFC	– Alabama Association for Marriage and Family Counseling: Serves to enhance marriage and families by fostering programs of education, promoting and conducting research, and working to remove family and couple difficulties.
ALAAOC	– Alabama Association for Addictions and Offender Counselors: Strives to support and enhance the practice of addiction and offender counseling.
ALAADA	– Alabama Association for Adult Development and Aging provides leadership, information, and professional development to counselors and service providers in the helping professions on matters related to counseling and development of adults across the life span.
ALMHCA	– Alabama Mental Health Counselors Association: Maintains and improves quality of mental health services nationwide and promotes prevention practices. (Affiliate)
ALSCA	– Alabama School Counselor Association: Provides a common framework for all professionals engaged in student services. (Affiliate)

ALCA MEMBERSHIP TYPES

- Professional Membership is open to all active American Counseling Association members and to all persons professionally engaged in guidance, counseling, or personnel activities in educational, vocational, religious, rehabilitation, employment agencies, or other such similar agencies. (Minimally holds Counseling Degree).
- Regular Membership shall include persons whose interests and activities are consistent with those of the Association, but who are not qualified for Professional Membership.
- Student Membership is open to any graduate or undergraduate student who is not employed full-time in a counseling-related position and who is actively engaged in a program of study in counseling, guidance, or personnel. (Certification by advisor is required).
- Retired Membership is open to persons who were members of ALCA at the time of their retirement.
- Past Presidents are persons who have served as ALCA Presidents: Dues are complimentary.

2021 Exhibitors and Advertisers

ACCESS Virtual Learning
Maria Kilgore
256 464-8370
mdkilgore@madisoncity.k12.al.us

Alabama Association for Play Therapy
Neely Haynes
256 577-0217
publicrelations@alaplaytherapy.org

Alabama Education Association
Kathy McVay
334 328-1444
gkmcvay@bellsouth.net

ALSANA
Megan Wetherbee
205 538-1209
megan.wetherbee@alsana.com

Athens State University
W Frank Eskridge, III
256 233-8162
frank.eskridge@athens.edu

Coastal Community College
Joseph Metz
251 580-8775
joseph.metz@coastalalabama.edu

Faulkner University
Olivia McDaniel
334 386-7422
omcdaniel@faulkner.edu

Glenwood Inc
Ashlin H Grant
205 970-1249
agrant@glenwood.org

ACT
Gennine Holley
205 578-2652
gennine.holley@act.org

Alabama Council on Compulsive
Gambling
Jack Galassini
205 423-5989
jack@alccg.org

Alabama Suicide Prevention Coalition
(ASPARC)
David Coombs
205 305-9210
dwcoombs2002@yahoo.com

Amridge University
Laina Costanza
334 387-7555
lainacostanza@amridgeuniversity.edu

Bradford Heath Services
Megan Campbell
205 251-7753
meganc@bradfordhealth.net

Elk River Treatment Program
Penny Baker
256 518-9998
smason@pinnacleprograms.com

FOCUS/SCJ Consultants, LLC
Sue C Jones
256 453-0655
sjones@thefocusprogram.com

High Cotton
Ceceilia Mills
334 669-1111
ceceiliamills@gmail.com

Alabama Homebuilders Association
Kory Boling
334 834-3006
koryboling@hbaa.org

Jacksonville State University
Lauren Findley
256-782-5265
lsthomas@jsu.edu

Laurel Oaks Behavioral Health Center
Terrie Butler
334 430-4592
terrie.butler@uhsinc.com

Medical Billing Professionals
Steven Zats
610 792-8819
steven@mbpros.com

National Center for Youth Issues
David Zumbrun
423 847-5362
dzumbrun@ncyi.org

Scentsy Independent Consultant
Carol Wells
205 531-1310
cwells227@gmail.com

Thrive Counseling & Psychiatry
Jeff Harrolle
205-479-3934
jharrolle@thrivetrauma.com

TNT Deizigns
Tomeka James
334 399-3760
tntdeizigns@yahoo.com

Vocational Evaluation Forensic Certificate
Program at Auburn
Emma Quadlander
334 844-2109
forensicrehab@auburn.edu

Wink Mobile Boutique
Cheryle Ray
205 515-8063
ray1265@bellsouth.net

The Horizon School
Shon Jackson
205 322-6606
sjackson@horizonsschool.org

Karen Maury Jewelry
Karen Maury
205 790-8349
kayrena16@gmail.com

Marco Products
Warren Funk
252 665-0496
warrenf@marcoproducts.com

NAMI Alabama
Kelly Emerson
334 396-4797
kemerson@namialabama.org

River Oaks Hospital
Madison Nyquist
madison.nyquist@uhsinc.com

Thriveway
Ruby McCullough
251 604-3781
ruby@thriveway.com

TouShay' Boutique
Shay Mason
256 227-3030
shay_au@hotmail.com

University of North Alabama
Courtney Shields
205-479-3934
cshields@una.edu

Wexford Health Services
Anna Flood
412-609-7353
aflood@wexfordhealth.com

Youthlight, Inc
Nanette Corbitt
803 767-6324
ncorbitt@youthlightbooks.com



BECOME A CERTIFIED GAMBLING COUNSELOR

HELP US HELP THOSE IN NEED.

Do you have a passion for helping others? If you have a desire to make a difference in the lives of others, help us help those with at-risk, problematic and disordered gambling by becoming an Alabama Certified Gambling Counselor.

**For more information, call
(334) 277-5100 or email
Jennifer Caradori at
jennifer@alccg.org.**

**Gambling has become a
pandemic in Alabama and
it can take many forms...**

- **CASINOS**
- **ONLINE GAMBLING**
- **SPORTS BETTING**
- **RAFFLES**
- **BINGO**
- **ONLINE GAMES**
- **LOOT BOXES**

HELP BUILD THEIR FUTURE WITH A CAREER IN HOME BUILDING



WHAT THE EXPERTS ARE SAYING:

BUREAU OF LABOR STATISTICS:

"Employment of construction and extraction occupations is projected to grow 10% from 2014 to 2024, faster than the average for all occupations, increasing from 6.5 million jobs to 7.2 million jobs."

AMERICAN COMMUNITY SURVEY:

"With half of all construction workers being older than 41, the construction workforce is aging and in great need of younger workers to fill positions."

U.S. CHAMBER OF COMMERCE COMMERCIAL CONSTRUCTION INDEX:

"88% of contractors report moderate-to-high levels of difficulty finding skilled workers. Of those, nearly half (45%) report a high level of difficulty."

NATIONAL ASSOCIATION OF HOME BUILDERS:

"The industry has a labor shortage of anywhere from 250,000 to 400,000 jobs, creating a significant skilled labor gap."

The ALABAMA HOME BUILDERS FOUNDATION

provides scholarships to students desiring to study the building trades at any two-year, four-year or technical school in Alabama. Contact Kory Boling at the AHB Foundation today to learn more about opportunities for your students.



ALABAMA HOME BUILDERS FOUNDATION
WWW.AHBFFOUNDATION.ORG
1-800-745-4222



BIRMINGHAM

Located in the rolling hills of Birmingham, Alabama, Alsana's Fitzgerald residential program and Harper day patient and intensive outpatient programs provide a continuum of care for clients journeying toward recovery.

Clients receive the highest quality and most current evidence-based therapies for eating disorders and their co-occurring conditions, provided by an exceptional multidisciplinary team of compassionate professionals.

Our program in Birmingham provides treatment for adults 18 and older of all genders suffering from anorexia, bulimia, binge eating disorder, OSFED, ARFID, and co-occurring conditions.

To meet our Birmingham staff, please visit our website.

alsana.com



THREE LEVELS OF CARE

Residential Treatment

- Home environment
- 24/7 on-site nursing
- 3 sessions/wk with Primary Therapist
- 2 sessions/wk with Registered Dietitian
- 1+ sessions/wk with Psychiatrist
- Up to 6 groups/day (process and skills)
- Weekly family group
- Family and friends week

Day Treatment

- Up to 12 hours/day of programming
- 3 sessions with Primary Therapist
- 1-2 sessions with Registered Dietitian
- 1+ sessions with Psychiatrist
- Up to 6 groups/day (process and skills)
- Supportive housing available
- Weekly family group
- Family and friends week

Intensive Outpatient

- Supervised snack and meal
- 1-2 sessions/wk with Primary Therapist
- 1 session/wk with Registered Dietitian
- 2 groups/day (process and skills)
- Weekly family group
- Family and friends week

**It's not how you
began your education
that matters.**

**It's how
you finish.**

KENNEDY
Early Childhood Education, '22



ATHENS STATE
UNIVERSITY



Learn More & Get Started Today at ATHENS.EDU!

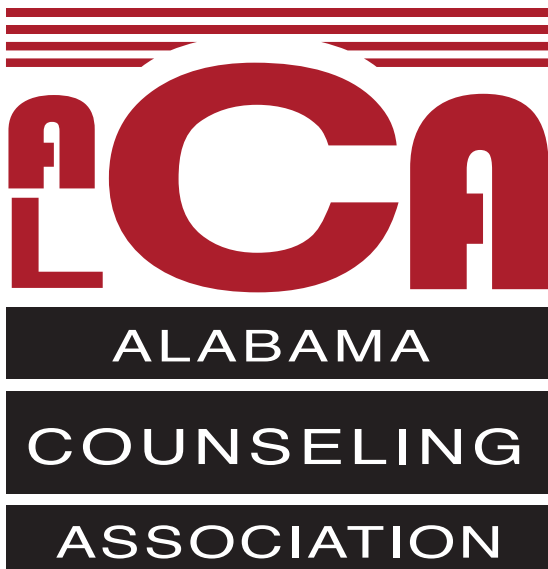

**THANK YOU
ALCA CHAPTERS,
DIVISIONS, AND
AFFILIATES!**

Proven Addiction Treatment Programs *for Real, Lasting Recovery*

Individual treatment plans designed to help people
confidently return to a healthy, productive life

Inpatient, outpatient, & specialty programs

Covered by most insurance plans

25+ locations across the Southeast

Over 40 years of successful outcomes

24/7 Confidential Help: **1-888-SOBER-40**

Visit us online at bradfordhealth.com



BRADFORD
HEALTH SERVICES



THE VOCATIONAL EVALUATION FORENSIC CERTIFICATE PROGRAM AT AUBURN UNIVERSITY IS NOW ACCEPTING APPLICATIONS FOR FALL 2022

This training certificate will increase your knowledge in forensics and vocational evaluation skills applicable to the field of rehabilitation.

Prospective students, students and professionals currently in the field are invited to apply.

Classes available on campus and distance education (online).

DURATION: One year to complete six courses including vocational evaluation and forensic rehabilitation.

FINANCIAL ASSISTANCE: Scholarships are available but competitive.

SUBMISSION DEADLINE: February 25th, 2022, applications are reviewed as received.

APPLICATION: aub.ie/grad-application

LEARN MORE: vefc.auburn.edu

CONTACT: forensicarehab@auburn.edu



Auburn University is an equal opportunity educational institution/employer. ©2021, Auburn University College of Education

“The **advantage** of working with teens in a **therapeutic residential setting** is watching kids get **better**, much **faster** than in an outpatient setting.” - Elk River Counselor

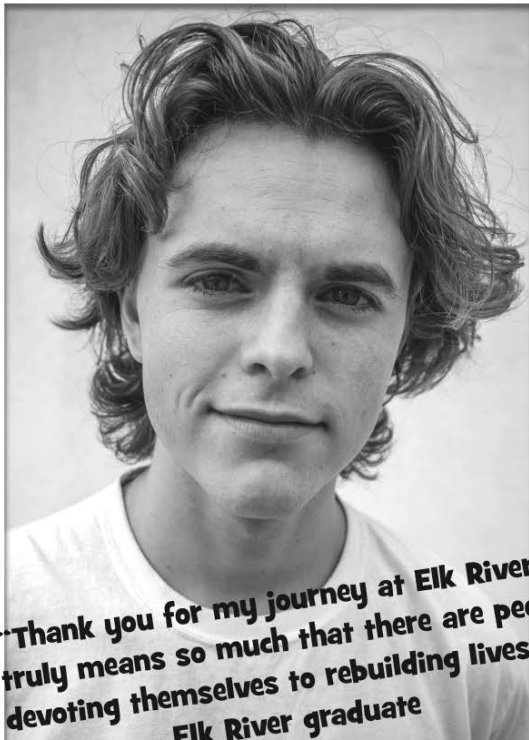

Elk River
TREATMENT PROGRAM
A Pinnacle Behavioral Health Program

Transforming lives
one child at a time.

NOW HIRING

Call (256) 518-9998 or email
Director of Clinical Services

Penny Baker, LPC-S

pbaker@PinnaclePrograms.com

- Located on 120 Beautiful Acres in North Alabama
- Administrative Offices in Huntsville, AL
- Multidisciplinary Treatment Team led by a Child and Adolescent Forensic Psychiatrist
- Residential and Academic Programs for Ages 12 - 18 Since 2006
- Accredited in Behavioral Health Care by The Joint Commission
- Year-Round School for Grades 6 - 12, Accredited by Cognia
- Competitive Pay and Benefits: Medical, Dental, 401K Options



Make A Difference!



FOCUS is a statewide effort that provides an opportunity for students to engage in student-led prevention of adolescent risk behaviors!

Project Funded by



**Scan here to learn more and
for free school registration!**



**Visit our exhibit
& register to win!**

Visit thefocusprogram.com for more information

Like us and follow us on social @alabamafocus





Life Touch
massage
"Relief is only a touch away"



1223 2ND AVENUE SOUTH
BIRMINGHAM, AL 35233
(205)718-5144
WWW.LIFETOUCHAL.COM

Additional Services:

- Group Events/Spa Parties
- Corporate Chair Massage



WWW.FACEBOOK.COM/LIFTOUCHAL



WWW.INSTAGRAM.COM/LIFTOUCHAL

WWW.LIFETOUCHAL.COM



Medical Billing Professionals Mental Health Billing Service

Register for our Platinum or PremiumPlus Service and:

- Receive the first month free
- Save 10% off our standard rate for the first year
 - Pay as low as \$2.61 per claim with this special rate
- Save 20% off the prepayment rates during the first year
 - Pay as low as \$1.75 per claim with this special

-
-  **TherapyNotes™** Users: Ask How We Can Help You.
 - Using a billing service charging a percentage? STOP throwing your money away.

For more details and FAQ, visit:
<https://specials.mbpros.com/alcounseling2021>

info@mbpros.com • <https://specials.mbpros.com/alcounseling2021>
877-762-7767

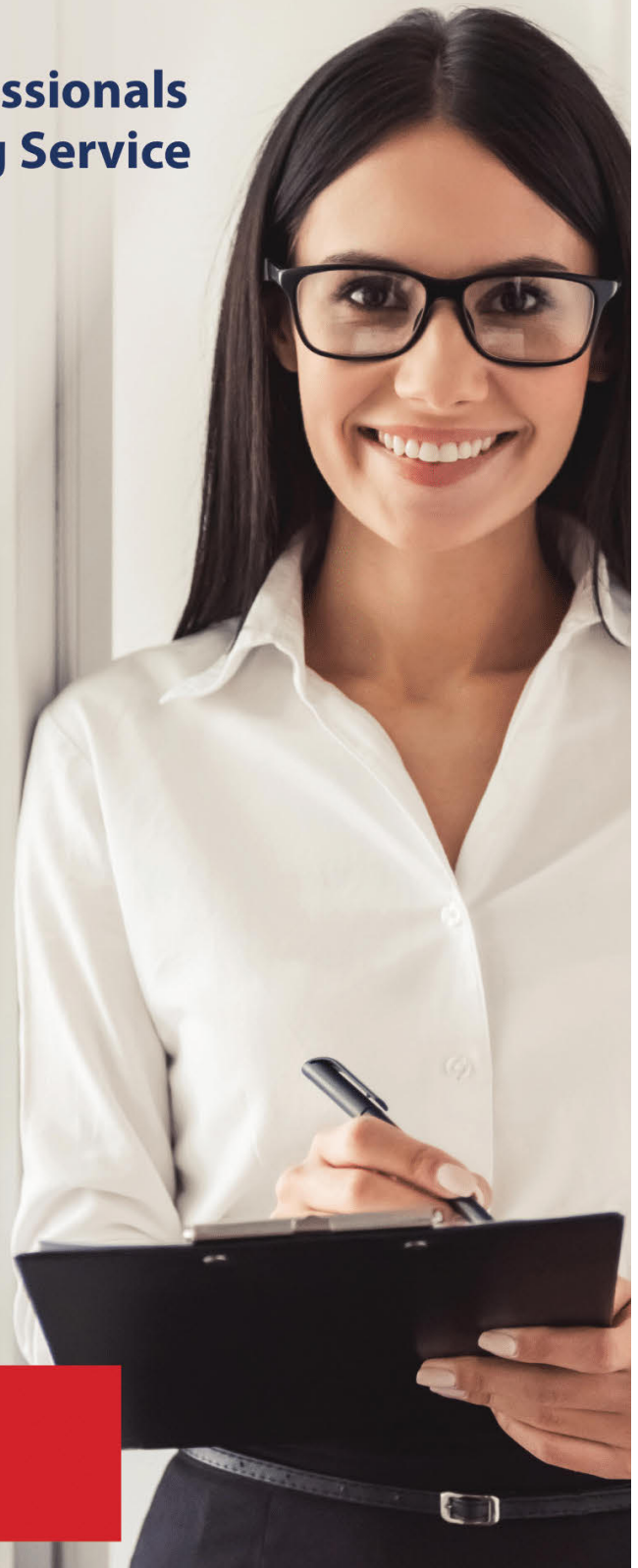

ALABAMA ASSOCIATION FOR PLAY
THERAPY INVITES YOU TO

*Come
Play
With
Us!*

*Unless someone like you cares a whole
awful lot, nothing is going to get better.
It's not. -Dr. Seuss*

[HTTPS://ALABAMAPLAYTHERAPY.ORG/](https://alabamaplaytherapy.org/)

*Stop by our booth for the chance to
win prizes and learn more about
the Alabama Association for Play
Therapy!*

Can't wait to see you there!





ESTABLISHED 1974

GLENWOOD

A Continuum of Care

Glenwood provided services to over 7,000 individuals in 2020, including:

- **Outpatient Services**
- **Residential Services**
- **Consultation & Training**
- **Education**

1 in 54 children will be diagnosed with autism and grow up on the spectrum. Make a difference today. Join us in helping to improve the lives of those with autism spectrum disorder.

For more information on services or employment opportunities, please visit Glenwood.org or call (205) 795-3203

150 Glenwood Lane, Birmingham, AL 35242



The Horizons School provides a community-based educational program promoting successful transition to paid employment and independent living for young adults with learning disabilities, autism spectrum and developmental disorders. Students work, live, and interact with the surrounding community on a daily basis. Our goal is to give them the skills and training opportunities needed to be employable, self-sufficient, fulfilled adults living in the community. For more than 28 years, our residential program has served adults ages 18 to 26 from all across the United States.



For more information or to schedule a tour, please contact Shon Jackson, Admissions & Transition Coordinator, at (205) 322-6606 or sjackson@horizonsschool.org.
horizonsschool.org





Wexford Health is proud to support the Alabama Counseling Association.

As a leading provider of correctional health care services, Wexford Health is now offering fulfilling career opportunities to **Licensed Mental Health Professionals** throughout the state of Alabama. Make a positive impact in the lives of an underserved population, while enjoying great pay, job security, and room for growth.

To learn more about a career at Wexford Health, visit jobs.wexfordhealth.com.



Wexford Health
SOURCES INCORPORATED

Special Thanks to Our Sponsors

Alabama Home Builders Association – Breakfast

The Sheraton Hotel – Break

Wexford Health Services – Breakfast

ACT – Reception

**Alabama Council on Compulsive Gambling
Reception & Student Poster Session**

Bryant-Jordan Scholarship Program – Reception

Jacksonville State University – Dance

Amridge University – Breakfast

ALCA Chapters, Divisions & Affiliates – Breaks

**Special Thanks to Individual Contributors & the many wonderful
ALCA Conference Volunteers**

LISTSERV GUIDELINES

The ALCA Listserv is a service for active ALCA members. All an active ALCA member has to do to join the listserv at any time is contact THE ALCA OFFICE at alca@alabamacounseling.org to be added. However, each time you renew ALCA membership, please respond "Yes" to the question about the ALCA Listserv and you will subscribe to the ALCA Listserv. Answering "No" will not provide a subscription. ALCA Listserv subscriptions are active for one year. When your ALCA membership expires there is a 30 day grace period for the ALCA Listserv subscription, after which you will be automatically unsubscribed.

PERFORMANCE DISCLAIMER: The ALCA listserv is intended simply as a service and convenience to our membership. Information is posted on the listserv at the request of members and others who have information that it appears would be of interest to our members. Inclusion on the listserv should not be viewed as an acknowledgement or endorsement of the accuracy of the information being provided. This is simply an information venue. ALCA assumes no liability resulting from the use of this service. Consumers are advised to screen information as they would any other information source. ALCA reserves the right to determine which items will/will not go out on its listserv.

Please note the following hints that should make us all more effective in using the ALCA Listserv:

1. Remember the ALCA Listserv is a monitored listserv. This means that only the listserv manager may place a message on the listserv. By handling messages this way, we filter so that only items which should be of interest to counselors go out to ALCA Listserv subscribers. If you are not interested in a certain message, simply delete it- if you are Chapter X you may not care about Chapter Y news, but there is no need telling us you are not interested in news from other groups-we are going to continue sending the messages for each Chapter/Division/Affiliate. We cannot separate items this finely on the listserv. Messages go to all or none.
2. Do remember that it is impossible to monitor and send according to each individual taste and philosophy/moral conviction. We do well, but occasionally something may go out that you think is unnecessary or with which you disagree. Such occasions invoke using the "delete" button for its intended purpose. While we certainly value and read your personal responses, getting one does not mean that we can only operate the listserv based on your individual concepts. We are a diverse and multi-opinioned group. We always try to be conscious of that fact.
3. If you hit "reply," the message only comes back to the ALCA Listserv manager. If you want to respond to a message, you must respond to the email address or phone number found inside the announcement. DO NOT HIT "REPLY". You are not responding to the message. You are only responding to the ALCA Listserv manager. The ALCA Listserv manager cannot answer your question, however, someone listed on the announcement can respond to you.
4. The only way to get a message posted is by sending it to the ALCA office (alca@alabamacounseling.org) and asking us to post it. We have been empowered to use our best judgment about whether a message is appropriate to send to all counselors. We consider whether or not the message would be of interest to a significant cross-section of our members. We try not to distribute advertisements about practices or events that seems to benefit the asker more than the target audience.
5. ALCA Listserv messages should be sent in "plain text" (part of body of email message) so that all we have to do is forward it. Many, many of our member servers routinely block attachments as SPAM or for security reasons. Even if not blocked, they are often too large for system servers to handle. If you think you are not receiving the ALCA Listserv announcements, please check your SPAM or junk files and see if your network system is blocking it. Then release it from there and you should correct that issue.
6. Announcement regarding events that are not sponsored by ALCA or its Chapter/Divisions/Affiliates are only sent when they appear to carry a possible benefit or interest to our members. We avoid promoting events that conflict with planned ALCA events. For example, we promote almost nothing that might affect attendance at the ALCA Annual Conference either in that timeframe (September, October, November, December) or in the conference's general location. Since Fall of the year is the time for our annual conference and recognizing that the primary purpose of our conference is training and professional development (including offering professional development hours), it is not very logical to promote events

for other individuals/entities that could be construed/interpreted as being in competition with our conference during this time frame. In particular this will apply during September/October/November/December timeframe. We will obviously continue to promote ALCA Chapter/Division/Affiliate events, but even those should try to avoid conflicts near the conference timeframe.

7. Effective March 1, 2013, we will no longer publicize office space/real estate as being available to colleagues.
8. Effective March 1, 2013, we will no longer as a matter of course send out individual requests to help locate a particular kind of counselor or one located in a specific area, etc. The ALCA Counselor Locator Service housed on our website was established for this purpose and should be used.

Remember that the ALCA Listserv is a membership benefit for active ALCA members. The announcements sent on the ALCA Listserv are sent to be of assistance to our members. ALCA Listserv is tied to ALCA membership and thereby if one does not renew membership one will be deleted thirty days after ALCA membership expires.

This may be more than you ever wanted to know, but reading and trying to adhere to these concepts will certainly make the listserv more effective.

ALCA Annual Conference (In-Person)

EVALUATION

Please tell us your opinion of this conference for the days you were here. Rate the appropriate category for each item with 1 being the lowest and 5 being the highest. Leave blank any item that does not apply to you. Answer both sides and return the completed form to the evaluation table. Thank you.

I attended (Check all that apply): Wednesday ____ Thursday ____ Friday ____

	Lowest			Highest	
OVERALL PROGRAM	1	2	3	4	5
Setting a theme for the conference					
Organization of presentations					
Overall effectiveness of presenters					
Awards presentations					
Activities on first day					
Activities on second day					
Activities on third day					
Speaker/opening session on Wednesday					
Speaker/general session on Thursday					
Speaker/closing session on Friday					

Most valuable guest speaker (Name): _____

ANCILLARY SERVICES	1	2	3	4	5
Pre-conference publicity					
Registration					
Conference program booklet as guide					
Exhibits					
Hospitality at sponsored breaks, receptions					
Quality of chapters, division/affiliate social functions					
Quality of luncheons, dinner, other socials					
Quality of services for new attendees					
Quality of services for student attendees					
Usefulness of other conference services					

CONFERENCE FACILITIES	1	2	3	4	5
Accommodations for disabilities					
Layout of conference at site					
Size and comfort of meeting rooms					
Housing accommodations at site					
Housing accommodations off site					
Site – city and facilities					
Food availability					
Food quality					
Overall rating of location					

	Lowest				Highest
GENERAL SESSION 1 Attended: Yes ___ No ___	1	2	3	4	5
Session was well organized and delivered					
Presenter was knowledgeable					
Session was helpful to me					

GENERAL SESSION 2 Attended: Yes ___ No ___	1	2	3	4	5
Session was well organized and delivered					
Presenter was knowledgeable					
Session was helpful to me					

GENERAL SESSION 3 Attended: Yes ___ No ___	1	2	3	4	5
Session was well organized and delivered					
Presenter was knowledgeable					
Session was helpful to me					

My Chapter: _____

1 Division/Affiliate: _____

2 Division/Affiliate: _____

Please list the three Content Sessions you most liked and found most useful. Tell why?

Please list any Content Sessions you would most like to add at future conferences.

Comments:

WE VALUE YOUR FEEDBACK

Turn this form in at the evaluation table in the Registration area, or complete the electronic submission at <https://alca.memberclicks.net/2021-in-person-conf-eval> or mail to:

Dr. Elizabeth Kelley Mautz
1012 Terrace Acres Circle
Auburn, AL 36830



Alabama Counseling Association GENERAL CONFERENCE SESSIONS REPORT Professional Development (NBCC) Contact Hours

The Alabama Counseling Association has been approved by NBCC as an Approved Continuing Education Provider, ACEP No. 2001. Programs that do not qualify for NBCC credit are clearly identified. The Alabama Counseling Association is solely responsible for all aspects of this program.

Full Name: _____

Address: _____
City State Zip

Telephone: _____ E-Mail: _____

YOU MUST BE REGISTERED FOR THE CONFERENCE TO CLAIM NBCC CONTACT HOURS.

You may report any of the following: Wednesday Morning Workshop Session (Keynote Speaker), Opening General Session (Keynote Speaker), Friday General Session (Keynote Speaker), or Content Sessions. Indicate below which programs you attended. Insert title and number of Content Sessions. You should request credit only for programs you attended in their entirety. Credit cannot be granted for ancillary programs, business meetings, committee meetings, luncheons, or receptions. **Credit cannot be granted for a program one presents.** Do not record programs with overlapping times. Presenter's signature not required.

Wednesday, November 17, 2021

10:00 AM - 12:00 PM Opening General Session Attended: Yes _____ No _____ 2.00

1:00 PM - 2:15 PM (Session # / Title) _____ 1.25

2:30 PM - 3:45 PM (Session # / Title) _____ 1.25

Thursday, November 18, 2021

8:30 AM - 10:15 AM General Session Attended: Yes _____ No _____ 1.75

10:30 AM - 11:45 AM (Session # / Title) _____ 1.25

1:30 PM - 2:45 PM (Session # / Title) _____ 1.25

3:00 PM - 4:15 PM (Session # / Title) _____ 1.25

4:30 PM - 5:45 PM (Session # / Title) _____ 1.25

Friday, November 19, 2021

8:30 AM - 10:00 AM Business & General Session Attended: Yes _____ No _____ 1.50

10:30 AM - 11:45 AM (Session # / Title) _____ 1.25

I certify that the information on this report form is complete and accurate. Total NBCC Contact Hours: _____

Signature: _____ Date: _____

Requests must be postmarked by January 31, 2022. Certificate will be mailed as soon as possible but no later than March 31, 2022. There is a \$5.00 processing fee (\$20 for non-members). Make check payable to ALCA. You may also process CE application with a credit card at this link: <https://alca.memberclicks.net/2021alca-in-person-ce-certificate-request>

\$20.00 charge for duplicate certificate requests and for requests submitted after January 31, 2022.

_____ Check if you plan to submit certificate to the Alabama State Board of Social Work Examiners.

Mail to: Dr. Deborah Grant, ALCA Professional Development Program, 2705 Royal Lane, Pelham, AL 35124

Persons who need to verify attendance at certain workshops (e.g., ethics) should attach a copy of this report form to the certificate when submitting papers to a licensing board.

Conference Notes

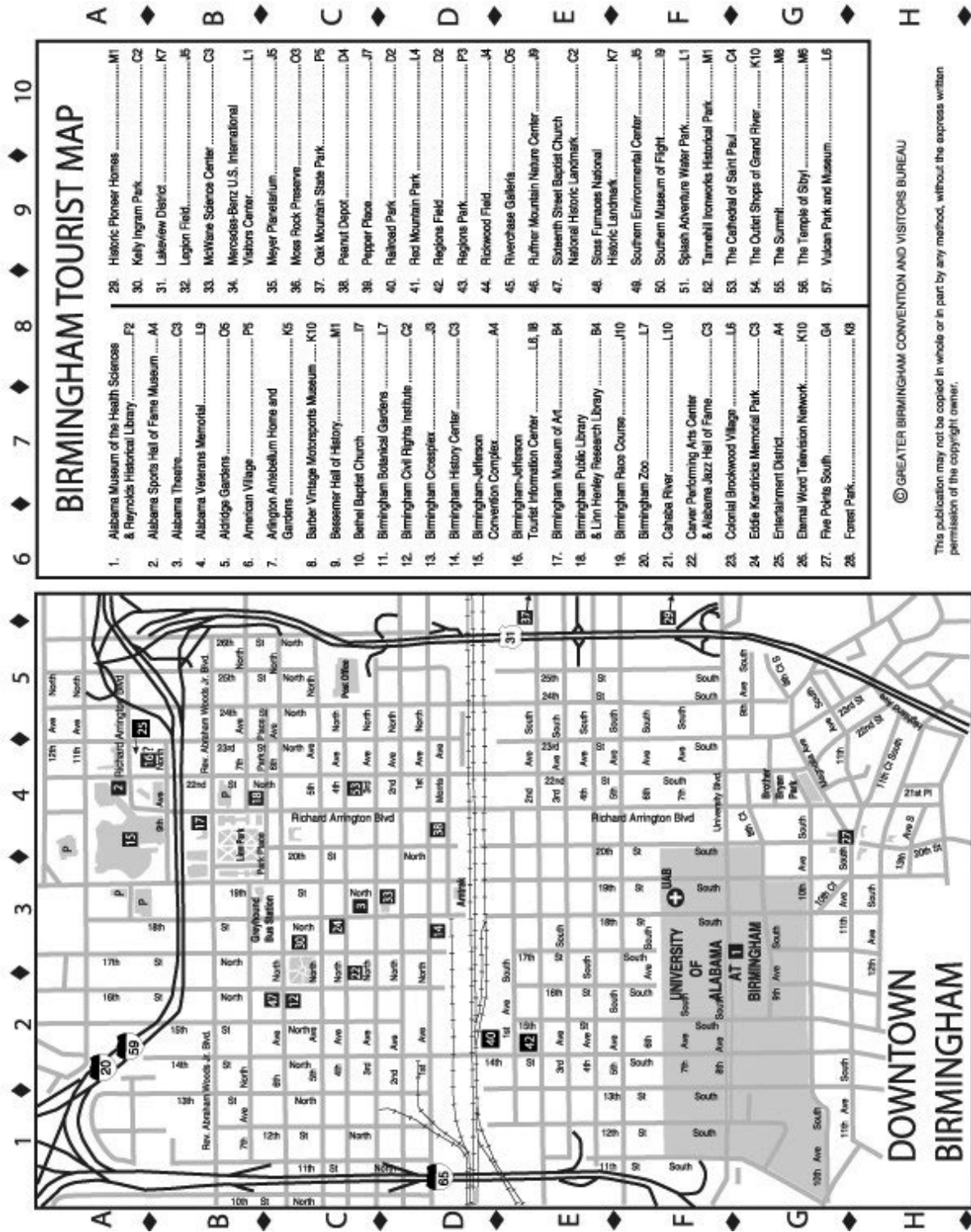

© GREATER BIRMINGHAM CONVENTION AND VISITORS BUREAU

This publication may not be copied in whole or in part by any method, without the express written permission of the copyright owner.

